

PLATES



Aerial view of the Upper Agora (‘Staatsmarkt’)



Bouleuterion and Basilica Stoa



1 Bouleuterion and *scaenae frons* in 1908

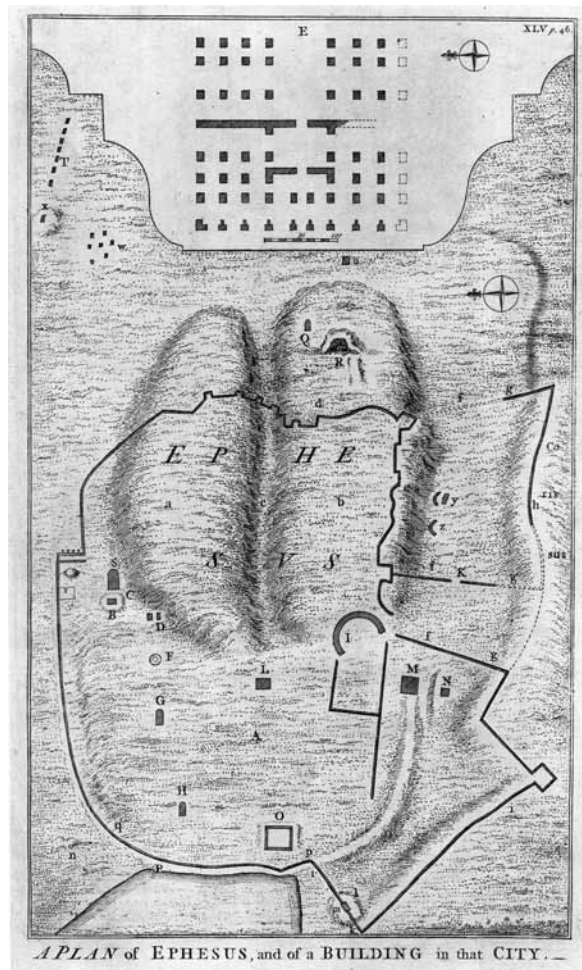

2 Plan of Ephesus
by R. Pococke,
published in 1745



1 View of the Bouleuterion after J. T. Wood (1877)

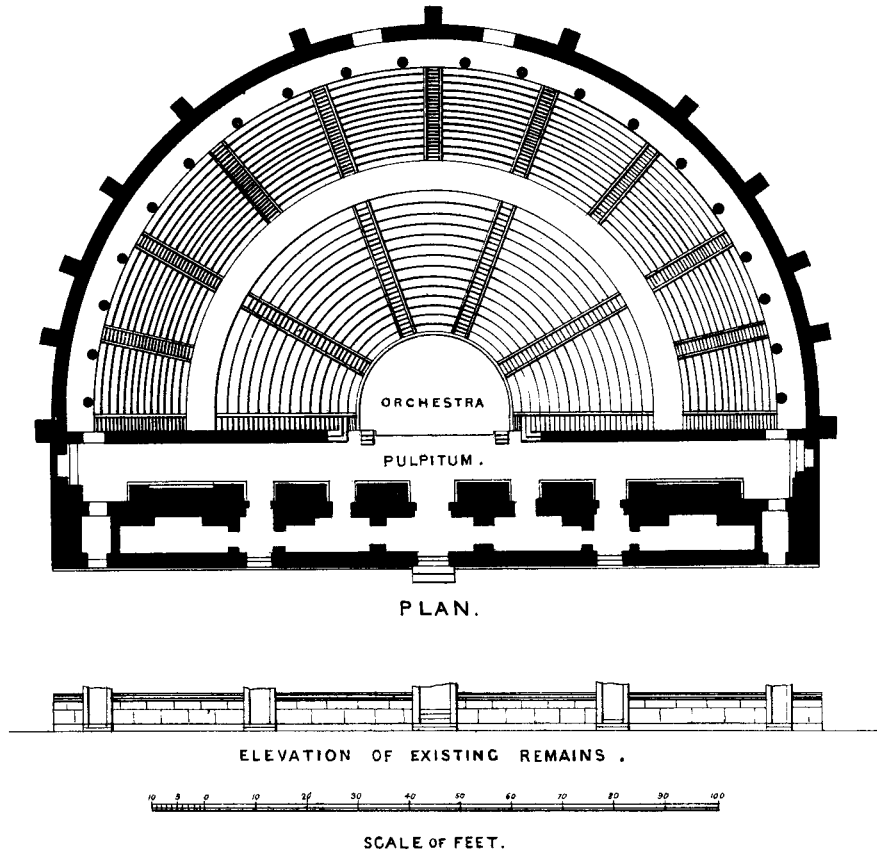

2 Reconstructed plan of the Bouleuterion after J. T. Wood (1877)

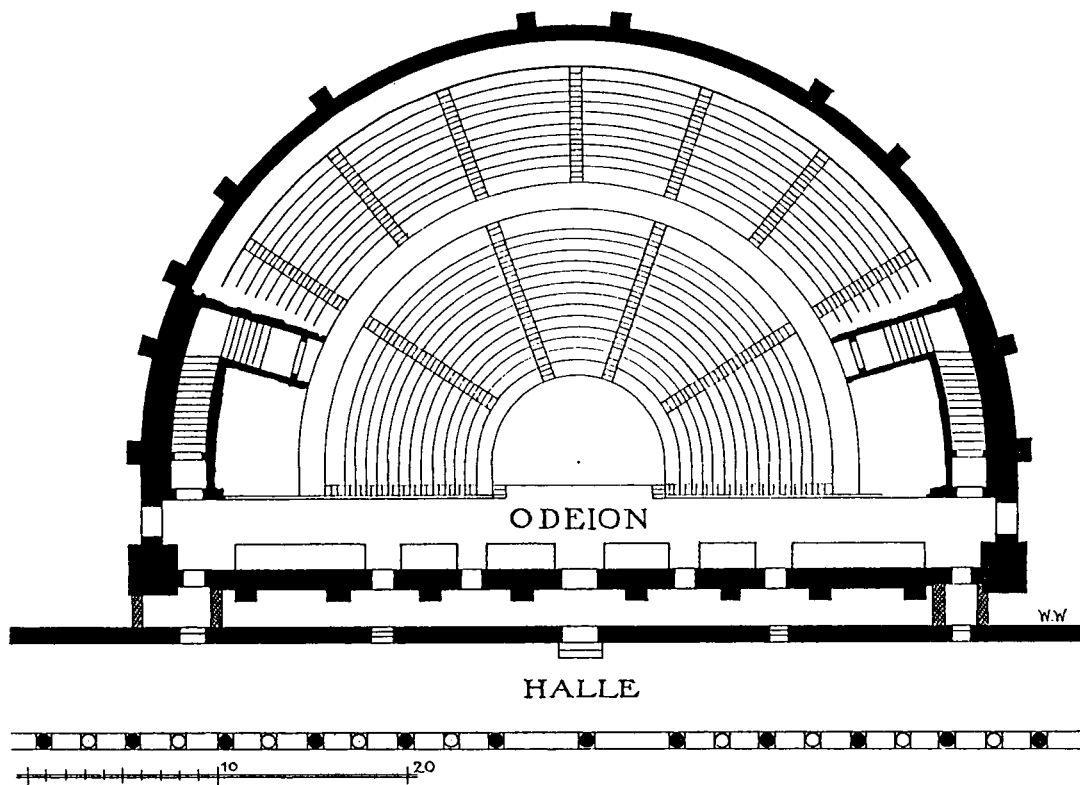

1 Reconstructed plan of the Bouleuterion by W. Wilberg (published in 1909)

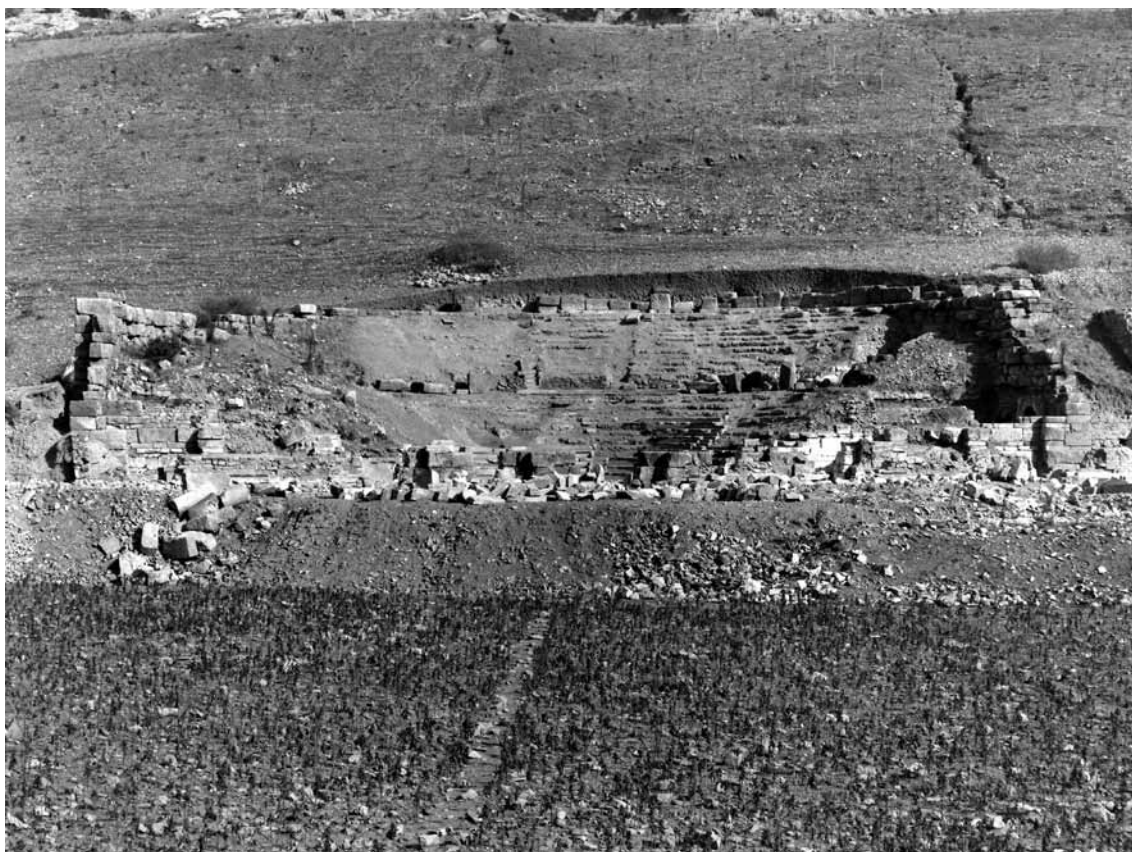

2 Bouleuterion from the south in 1908



1 *cavea*, west *parodos* and *pulpitum* in 1908

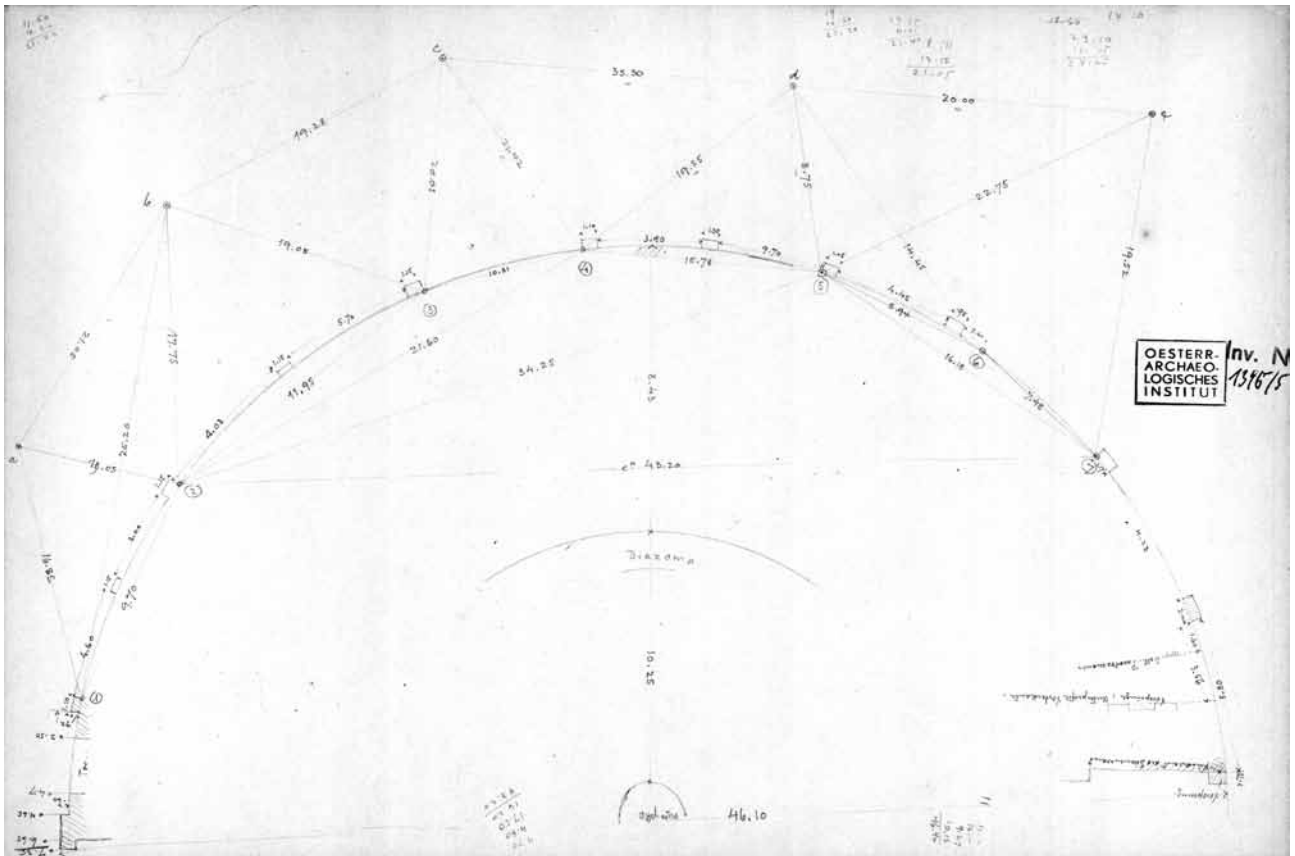

2 Drawing by W. Wilberg (1908), sketch of outer retaining wall

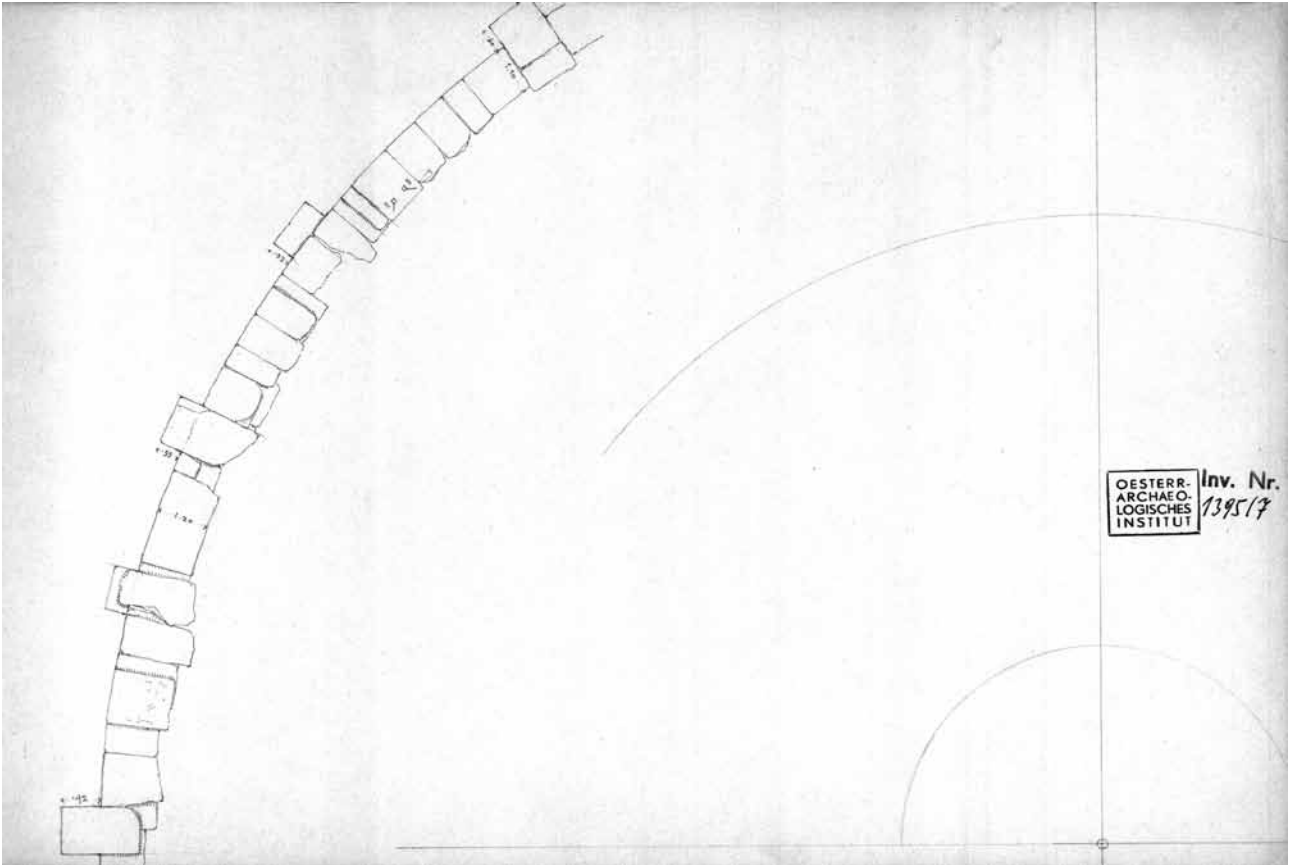

1 Drawing by W. Wilberg (1908), western part of enclosure wall

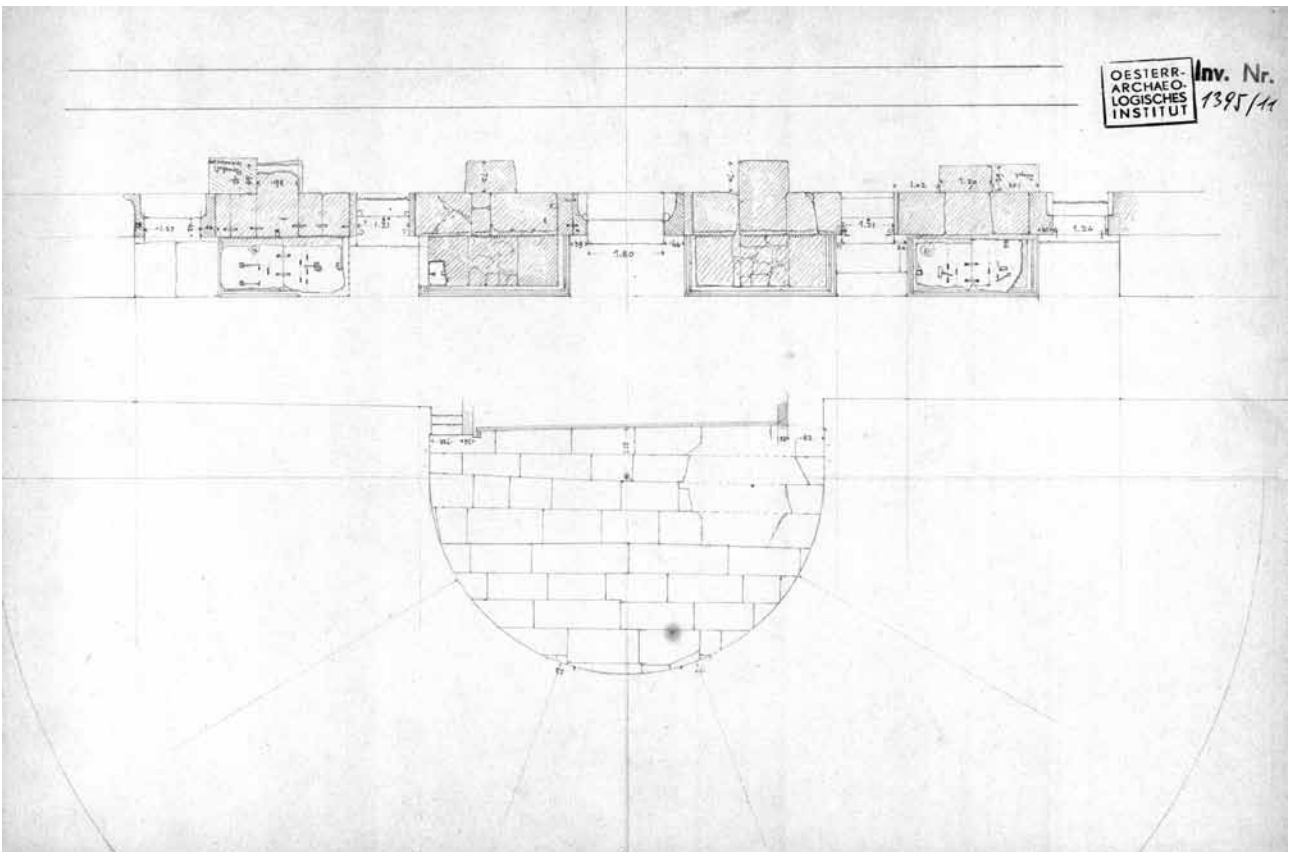

2 Drawing by W. Wilberg (1908), *scaenae frons* and orchestra

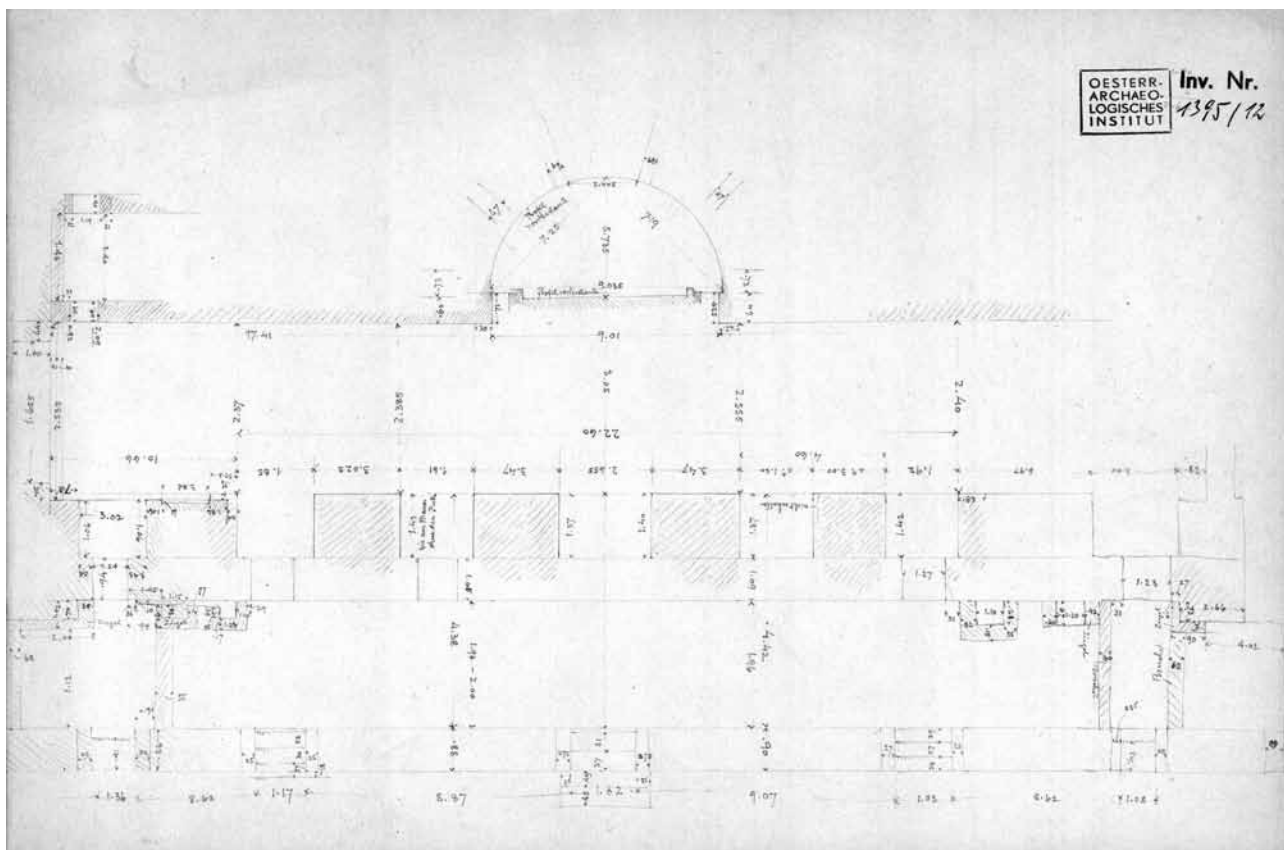

1 Drawing by W. Wilberg (1908), back stage corridor

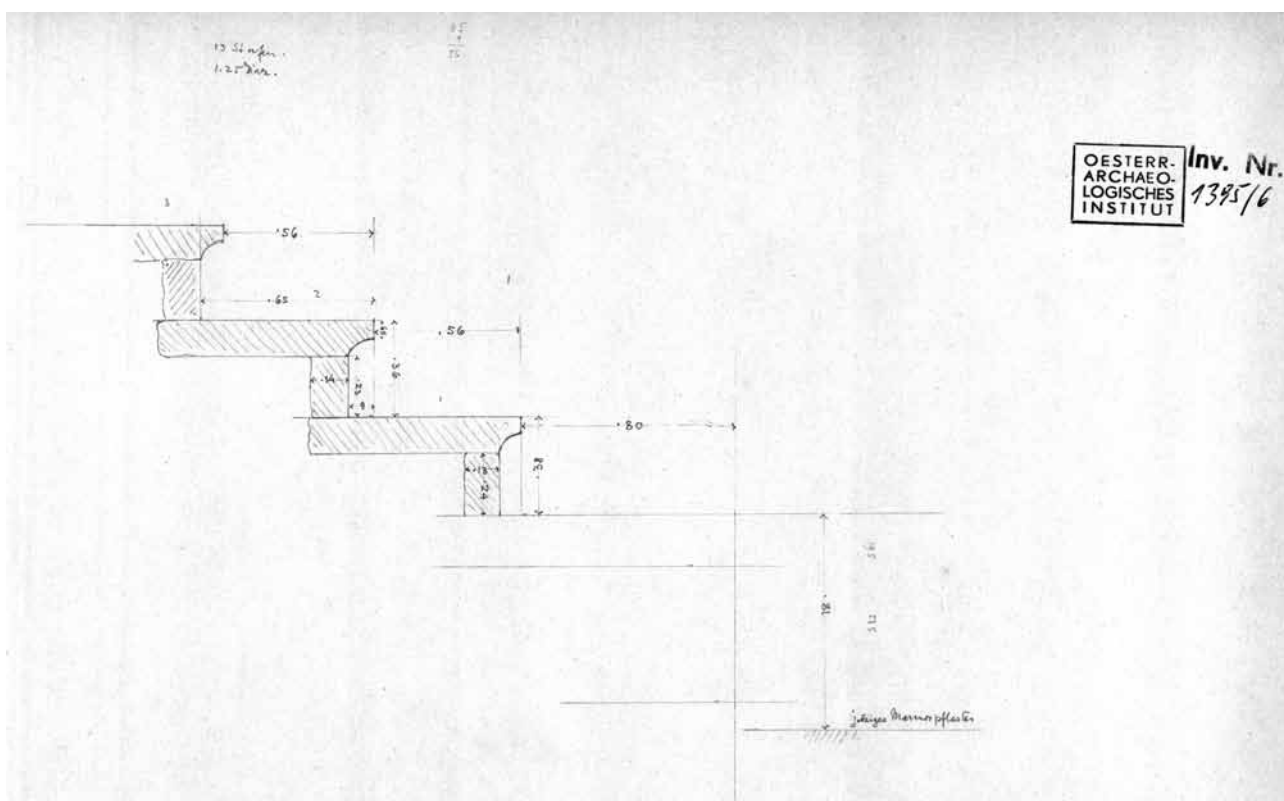

2 Drawing by W. Wilberg (1908), section through seats of lower cavea

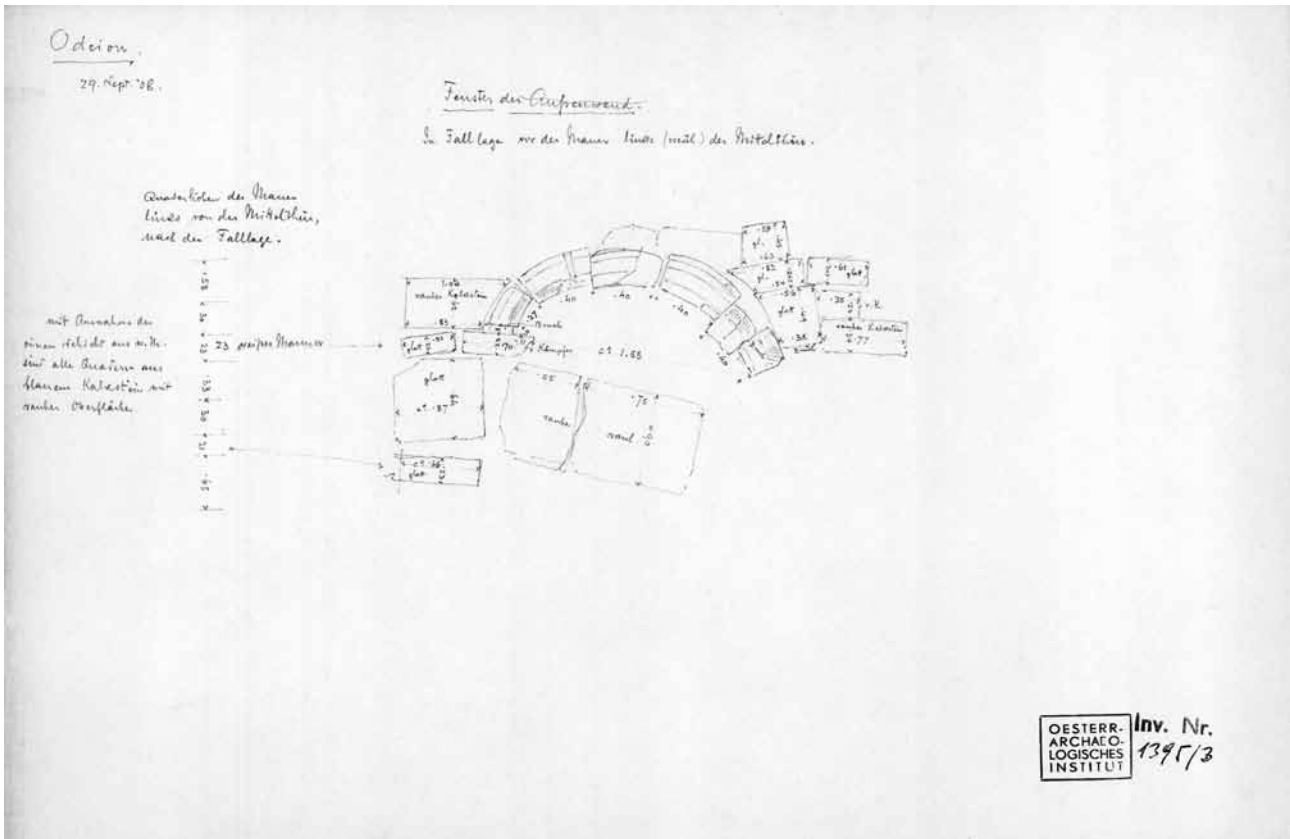

1 Drawing by W. Wilberg (1908), arch found west of central doorway (SD 4) of the Bouleuterion

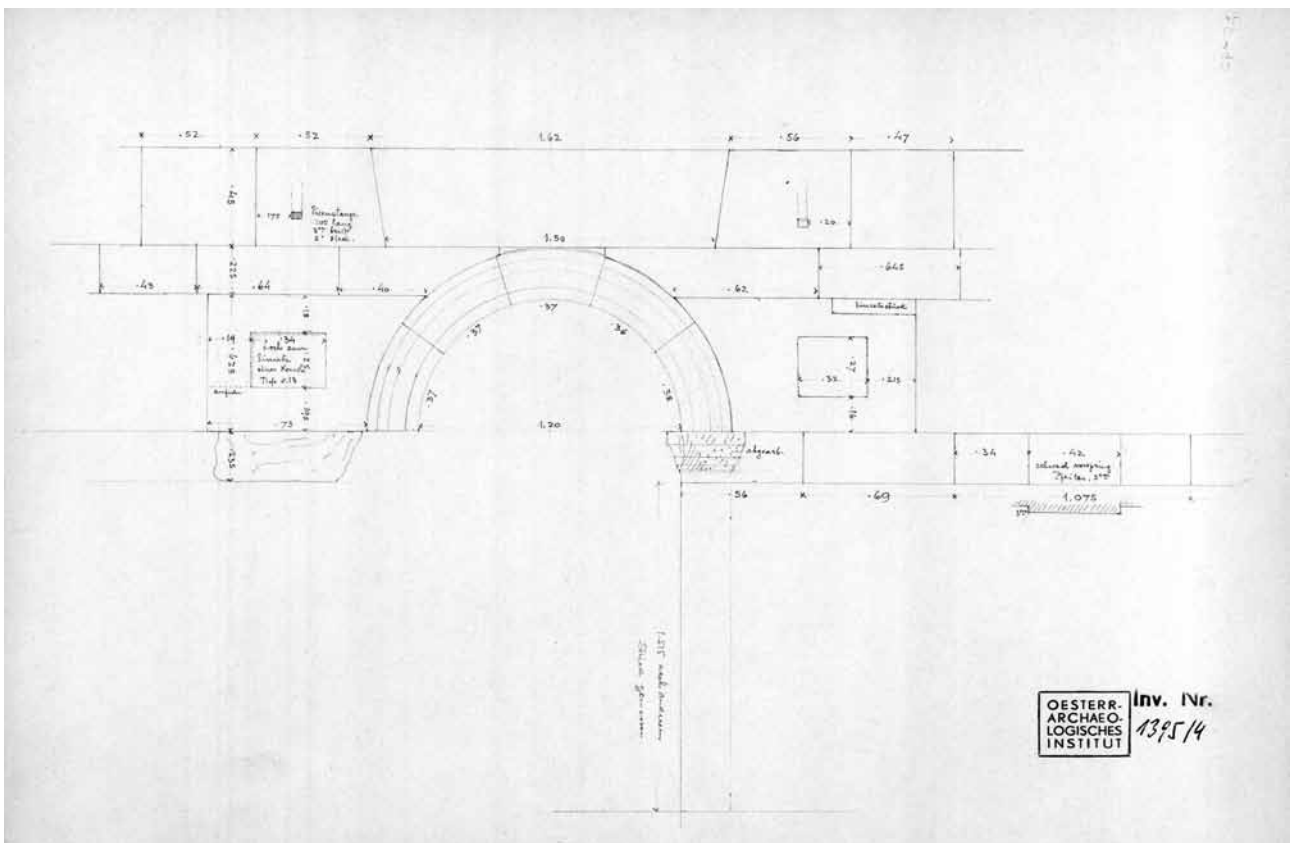

2 Drawing by W. Wilberg (1908), reconstruction of arch

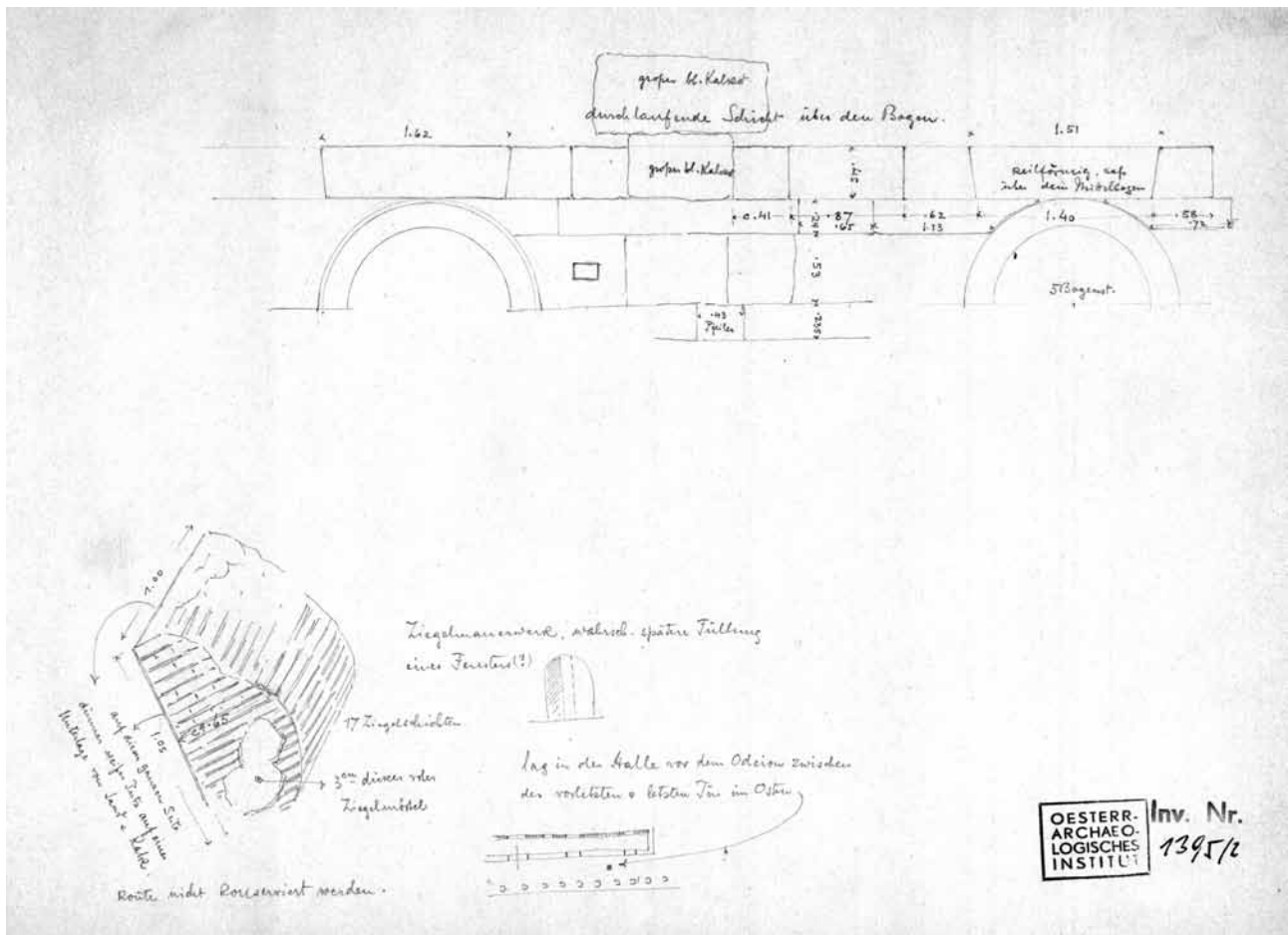

1 Drawing by W. Wilberg (1908), reconstruction sketch of arched openings and wall blocks



2 Bouleuterion from top of the west *analemma* wall in 1908



1 Orchestra and *cavea* in 1908



2 Orchestra and lower *cavea* in 1908



1 W. Alzinger's excavation in the orchestra in 1961 (H. Vettors in the foreground)

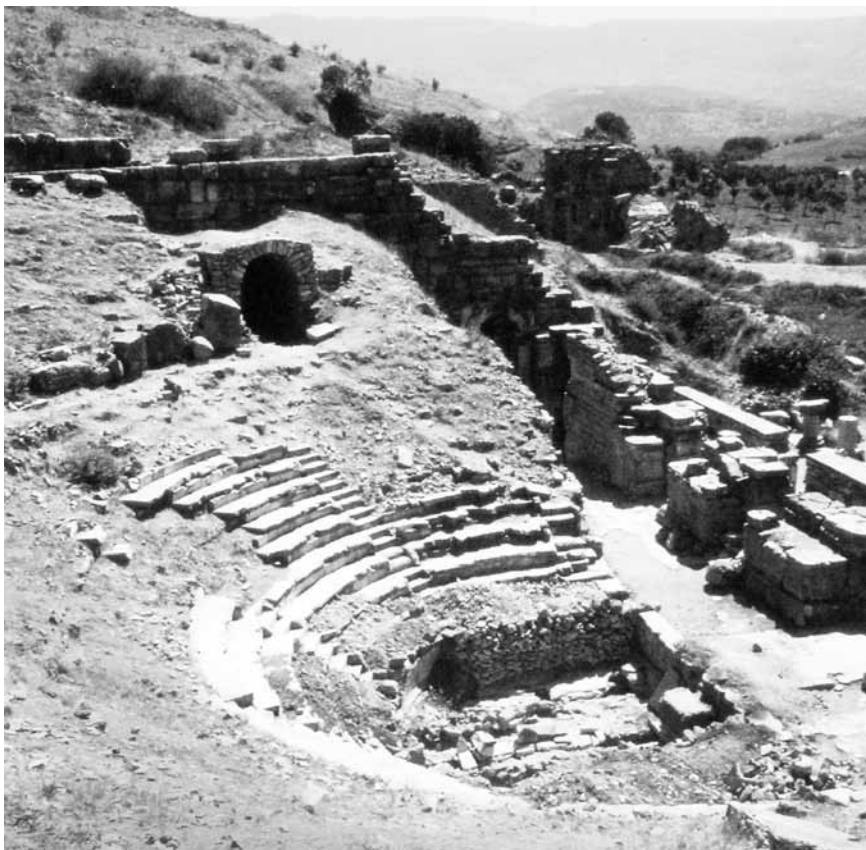

2 W. Alzinger's excavation in the orchestra in 1961 (east trench)

Plate 14



1 W. Alzinger's excavation in the orchestra in 1961 (west trench)



2 Remains of a wall underneath the orchestra (1961)



1 Trench in the *pulpitum* in 1970



2 Trench in the *pulpitum* in 1970

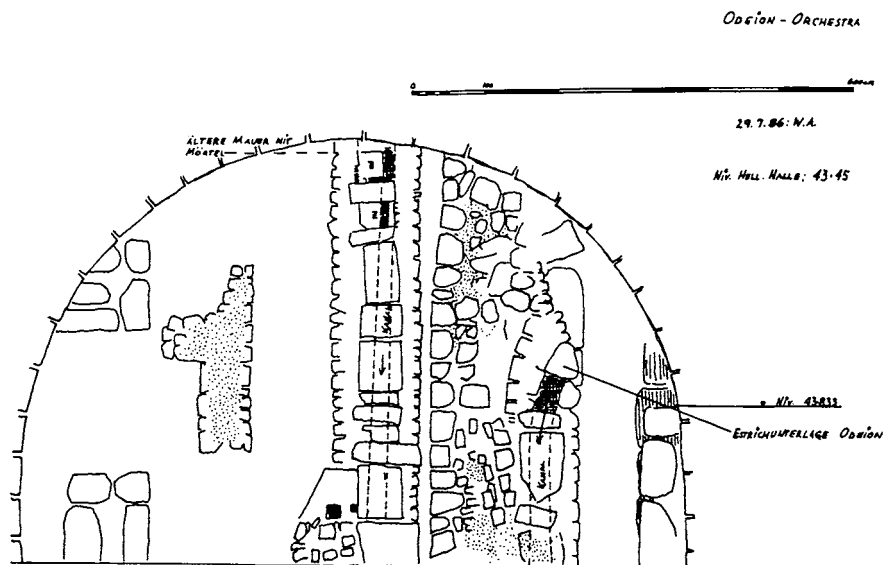

3 Sketch of W. Alzinger's trenches (1986)



1 Retaining wall of the *auditorium*, from the west



2 Retaining wall, detail between buttress 2 and 3

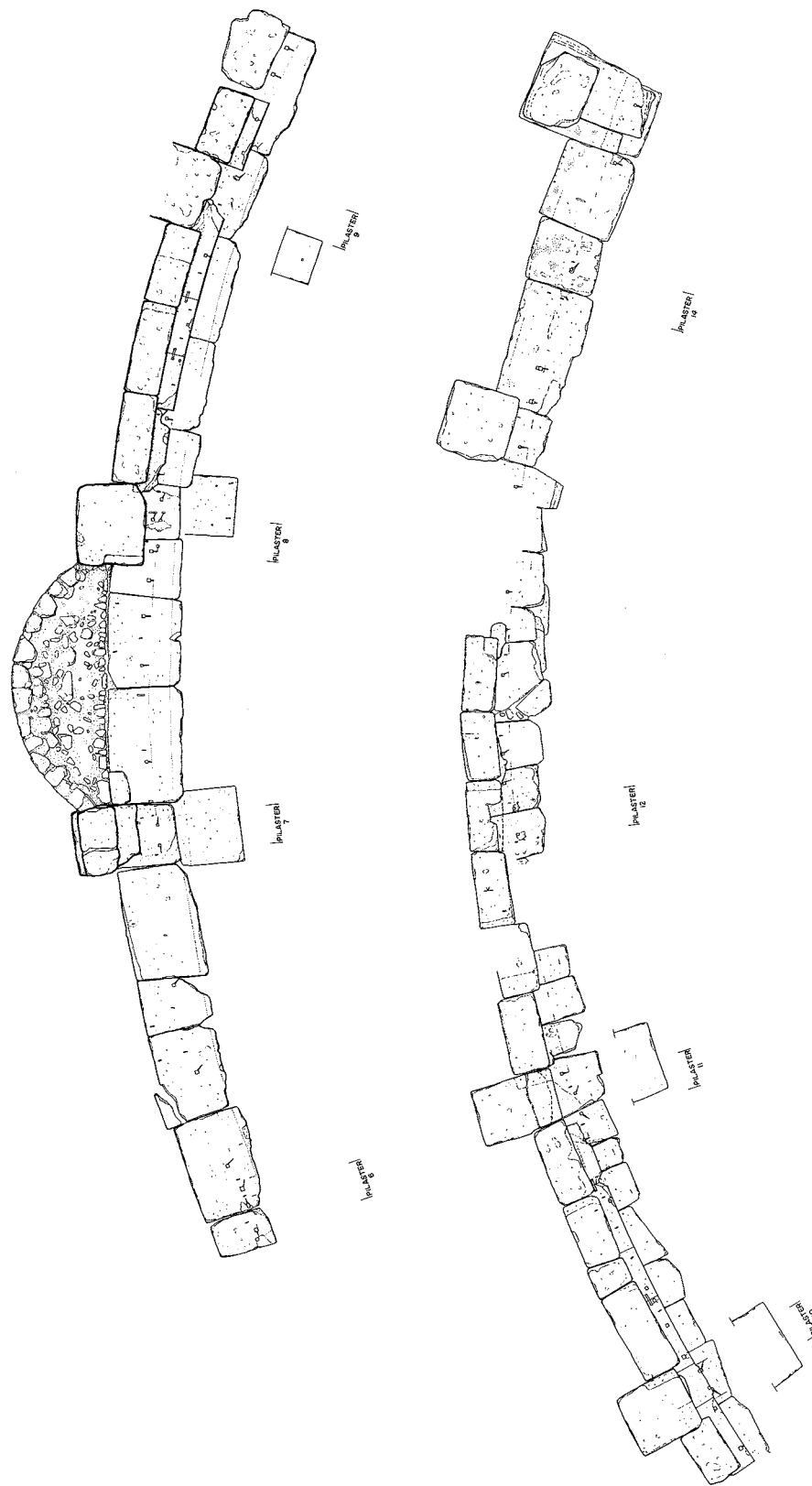

EPHEesos
BOULEUTERION
SEGMENTS OF REAR WALL WITH FOOTING SHOWING
CUTTINGS FOR REVETMENT AND PILASTER BASES
L. BIER, 2000
DRAWN 1/25 0 1 2 3 4m

Segments of the cavea's rear wall with traces of pilasters



1 Upper *cavea* and remains of rear wall



2 Inner ring of curved retaining wall: incisions and bedding surface



1 Dowel holes for revetment of rear wall with dado slabs

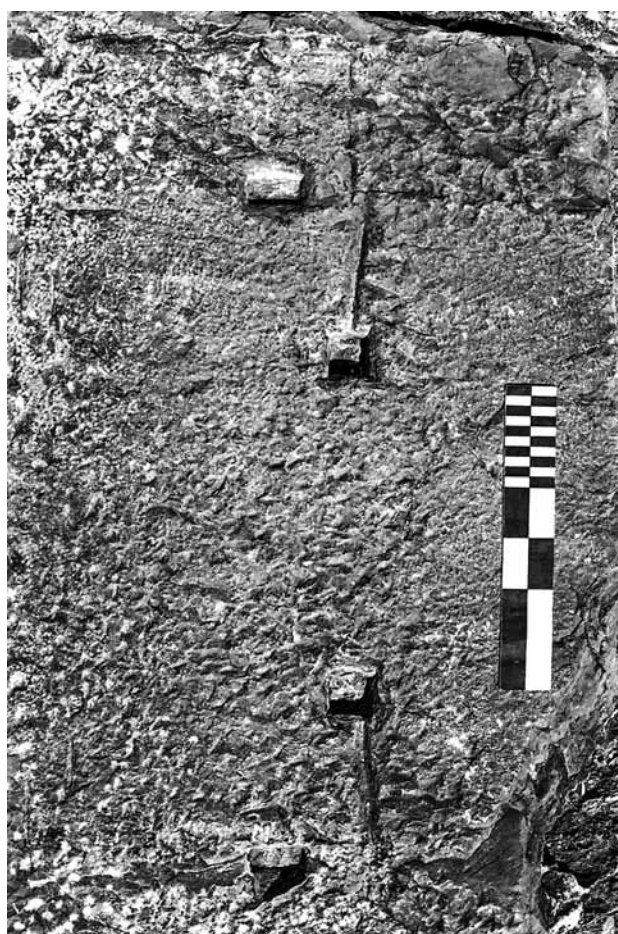

2 Pryholes and dowels for pilaster base



1 Remains of pilaster base on footing of rear wall

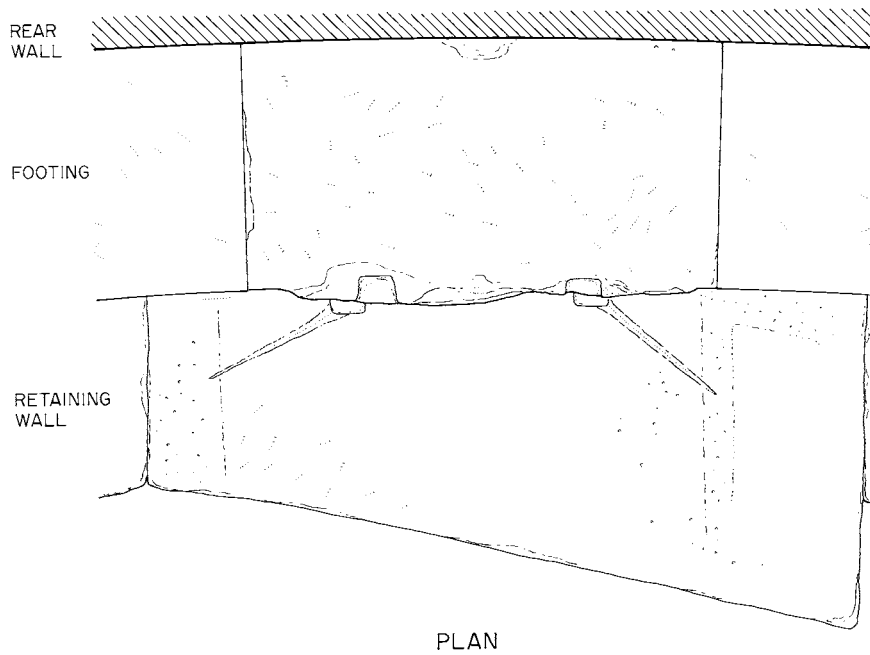

PLAN

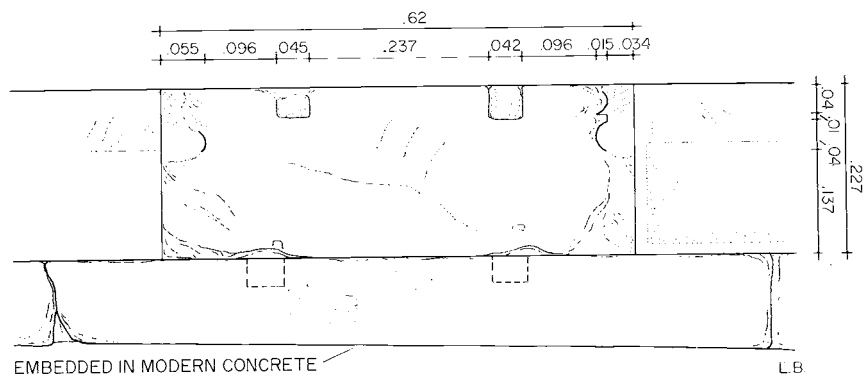

FRONT

2 Remains of pilaster base



1 Central apse in the rear wall



2 The *cavea* before modern restorations



1 *cavea* and Basilica Stoa, view towards southeast



2 Seating in the lower *cavea*

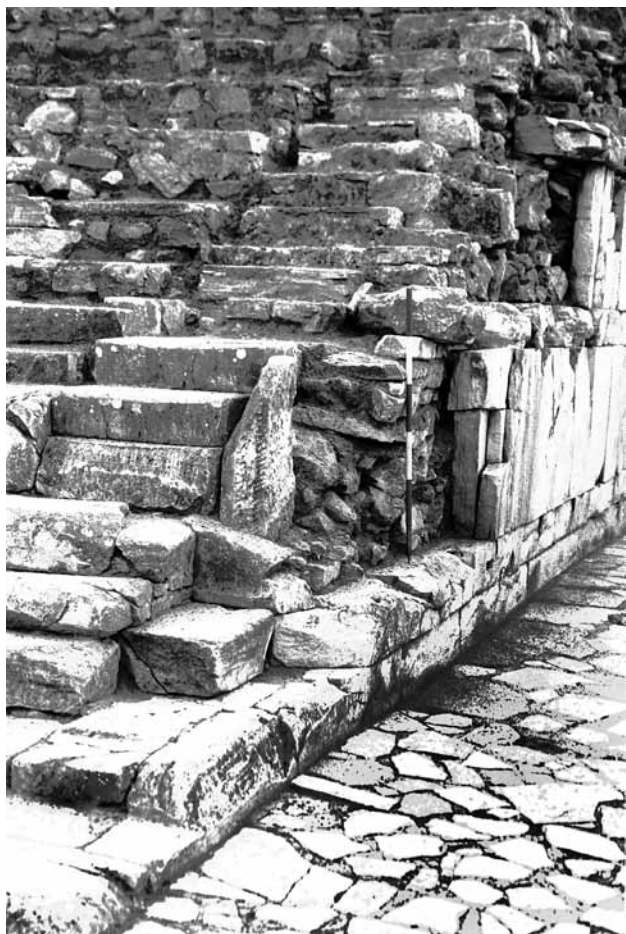

1 Steps skirting east *analemma*



2 Lion paw at the north end of *cuneus* E



3 Seating slab in row 7, *cuneus* D, with inscribed circle and dowel holes



1 Paving of the middle *diazoma*

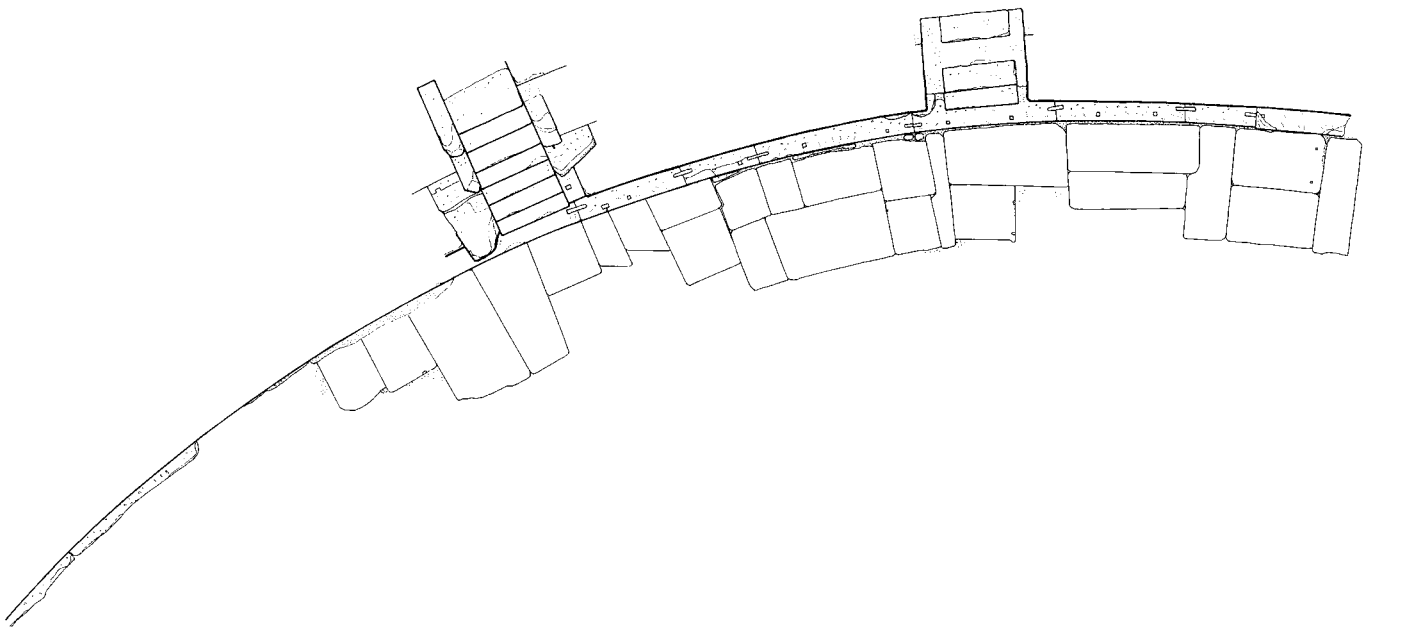

EPHESOS
BOULEUTERION
PRESERVED PORTIONS OF
DIAZOMA PAVING, PODIUM
FOOTING, AND STAIRWAYS
TO UPPER CAVEA

0 1 2 3m
DRAWN 1:25

L.BIER, 2000

2 Paving of the middle *diazoma*



1 Central stairway to the upper *diazoma*



2 East *analemma* wall



1 Surviving seat riser at the end of the first row of *cuneus* E



2 Vertical seam in the east *analemma* wall below the end of the *diazoma*



1 Marble block in south-east corner of orchestra



2 Springstone on top of east *analemma*



3 Vaulted chamber behind west *analemma*

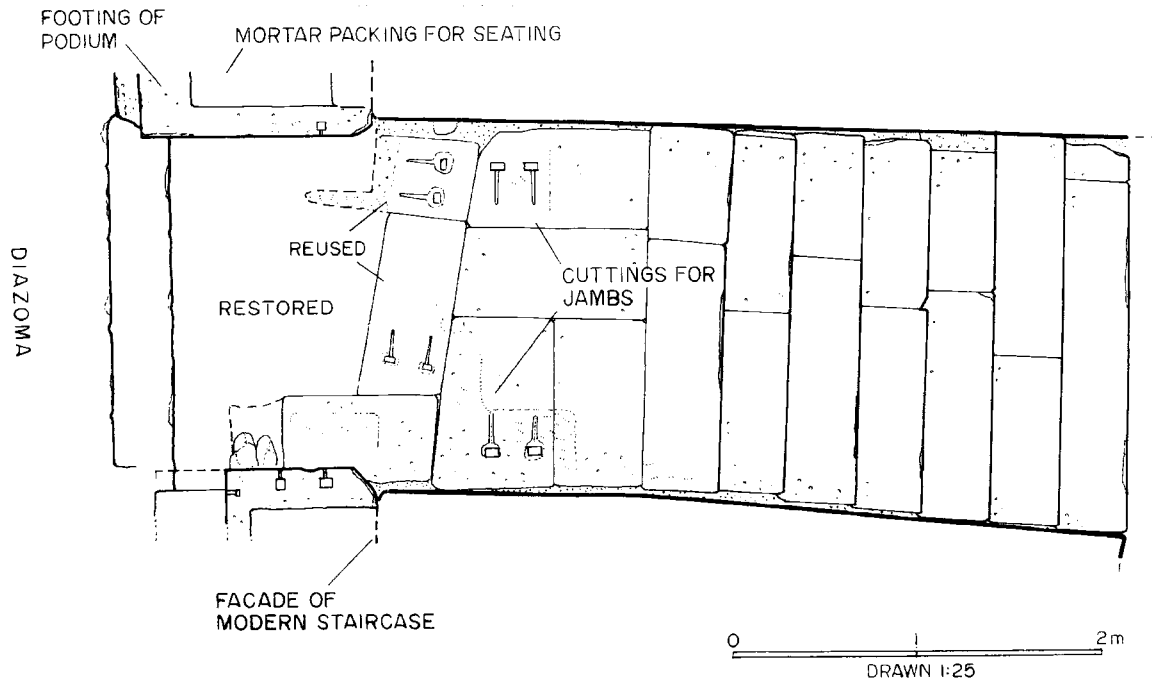

1 Eastern stairway



2 Landing of eastern stairway with dowel holes for piers

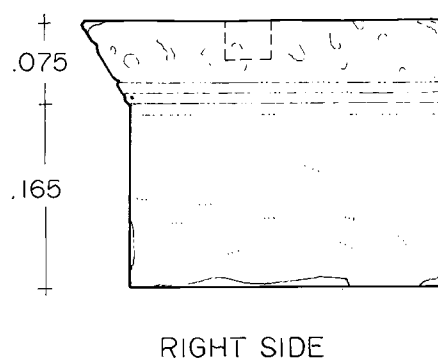
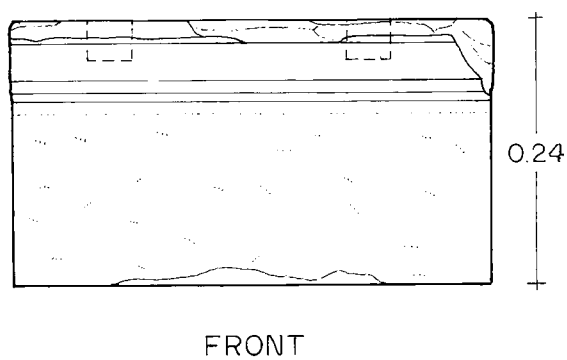
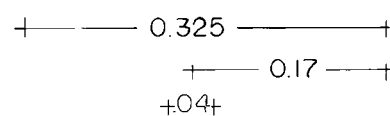
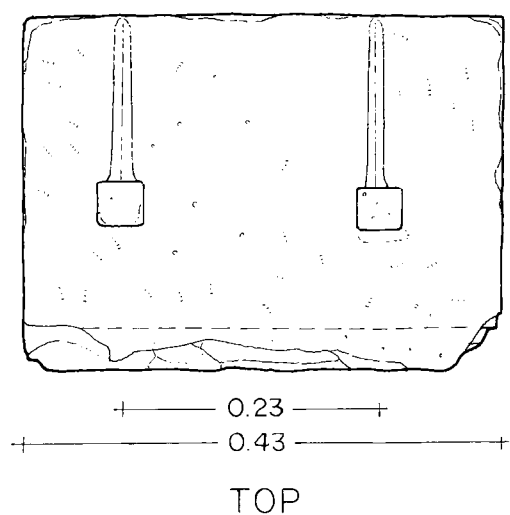

1 Pillar capital



2 Front of *pulpitum*