

WEST

62: Bilddokumentation Raum 15, W-Wand (M 1:25)

0 1m H2/15



OST

63.1: Z Raum 23, O-Wand (M 1:25)

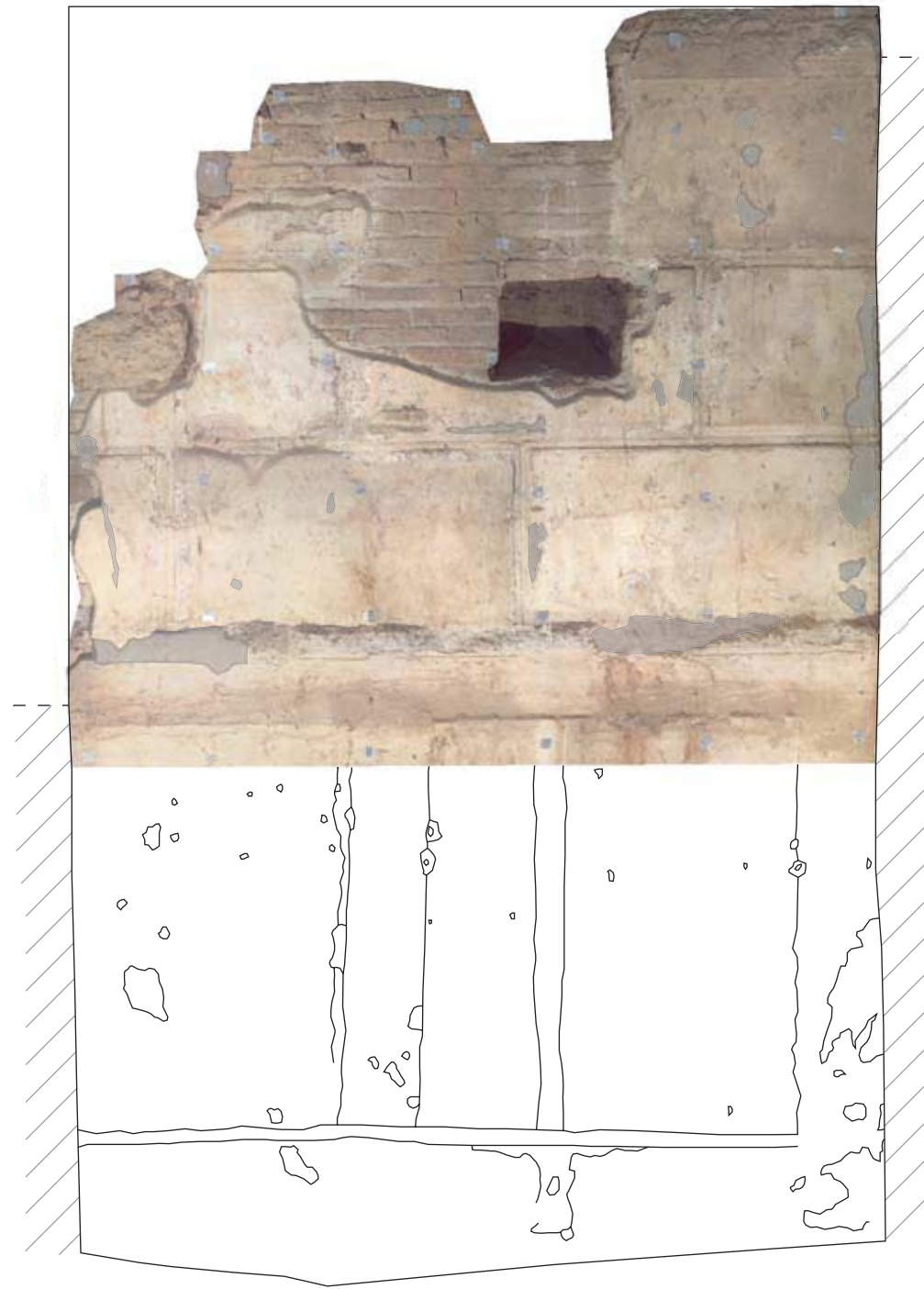

SÜD

63.2: Bilddokumentation-Z Raum 23, S-Wand (M 1:25)

UK + 30.67

0 1m H2/23

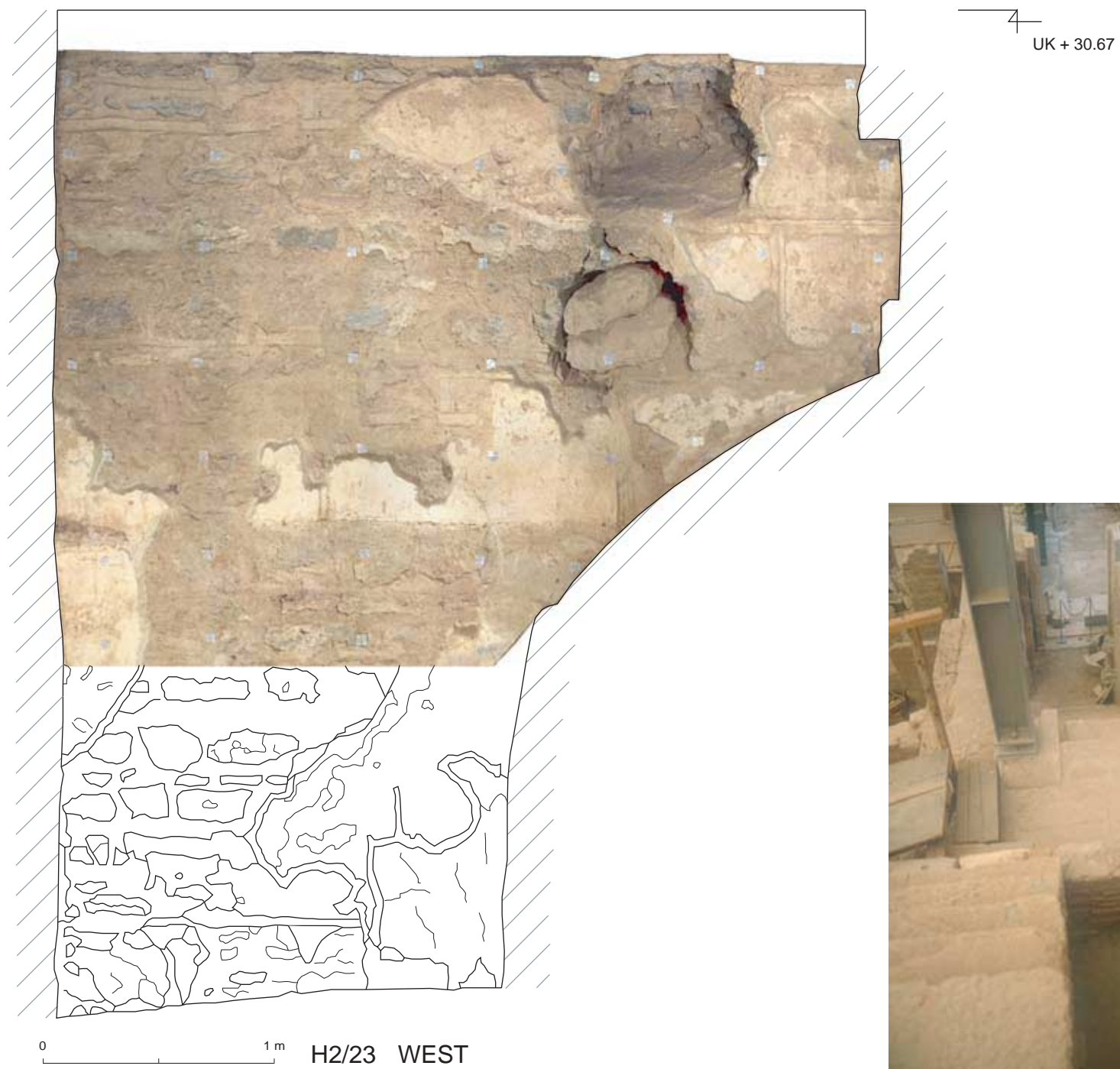

64.1: Bilddokumentation-Z Raum 23, W-Wand (M 1:25)



64.2: Raum 1 mit Resten der Nordwand



64.3: Raum 1 mit Stiege ins 2. OG, Grabungsphoto



64.4: Raum 1, Treppe ins 2. OG

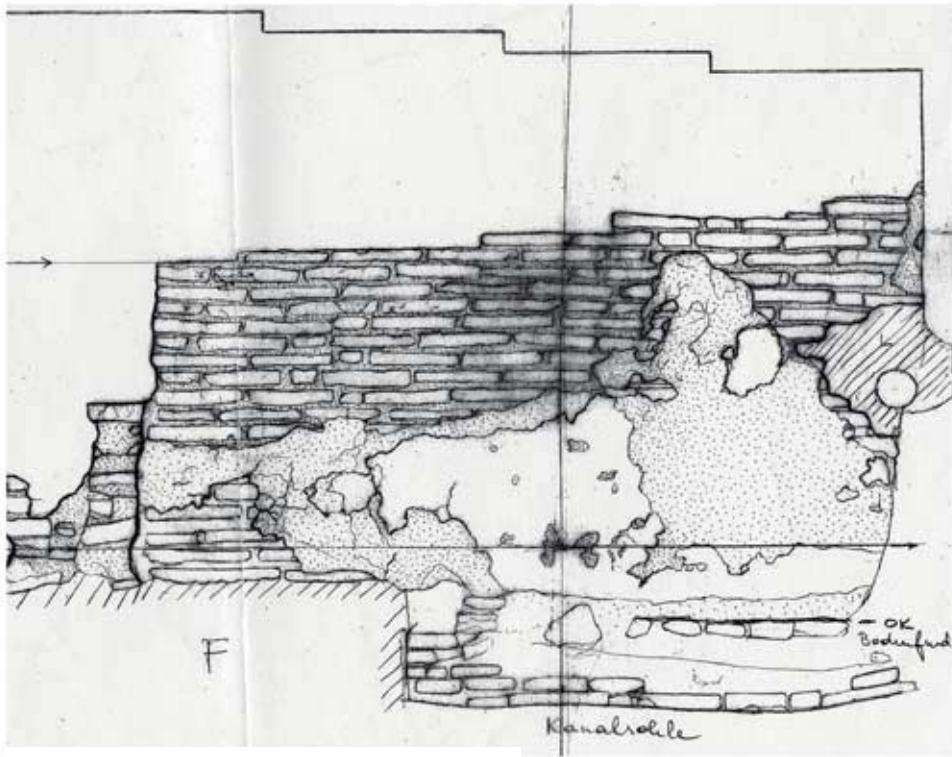

65.1: Z Raum SR 5d, S-Wand (M 1:25)

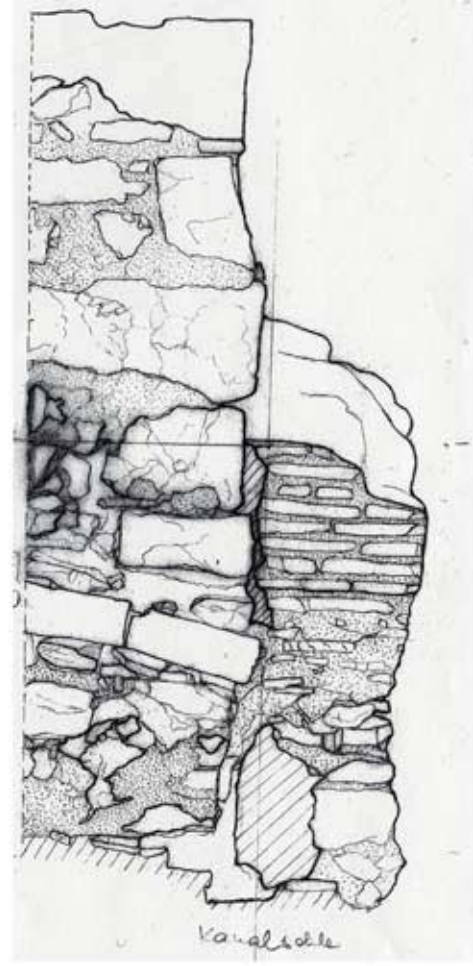

65.2: Z Raum SR 5d, W-Wand (M 1:25)



65.3: Raum SR 5d (2001)



65.4: Raum SR 9a (2001)

BODENPLATTEN IN SR 9

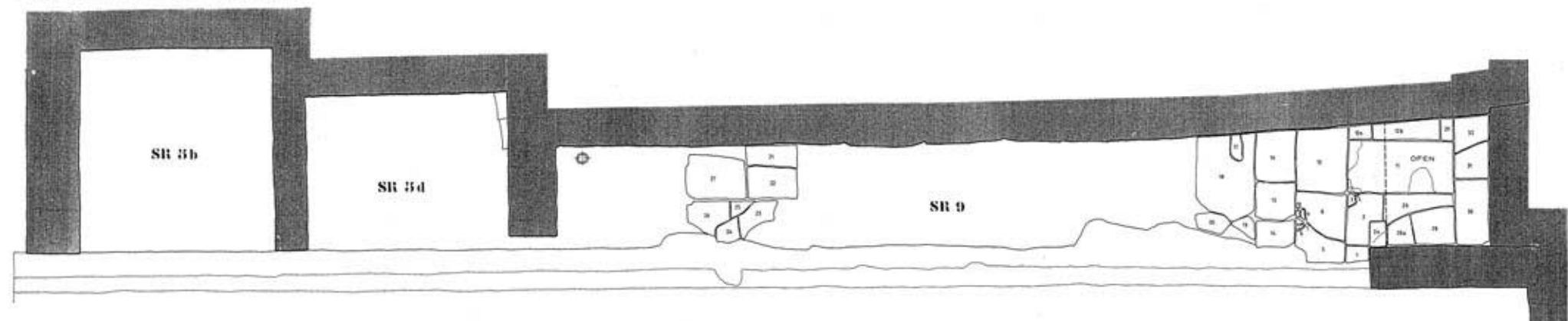

KANALSYSTEM IN SR 5b,d und SR 9

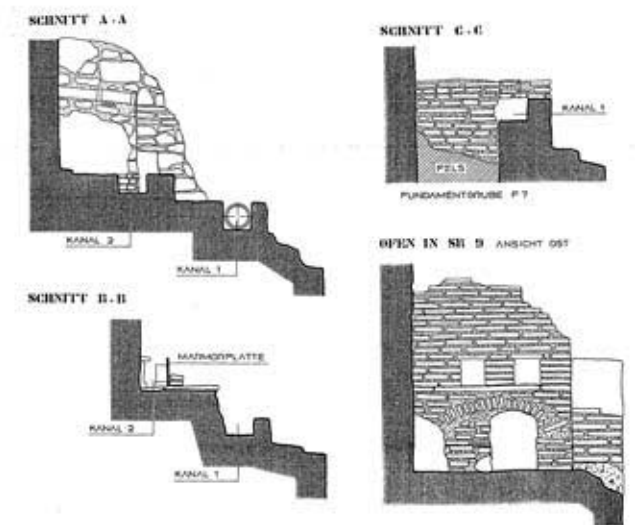
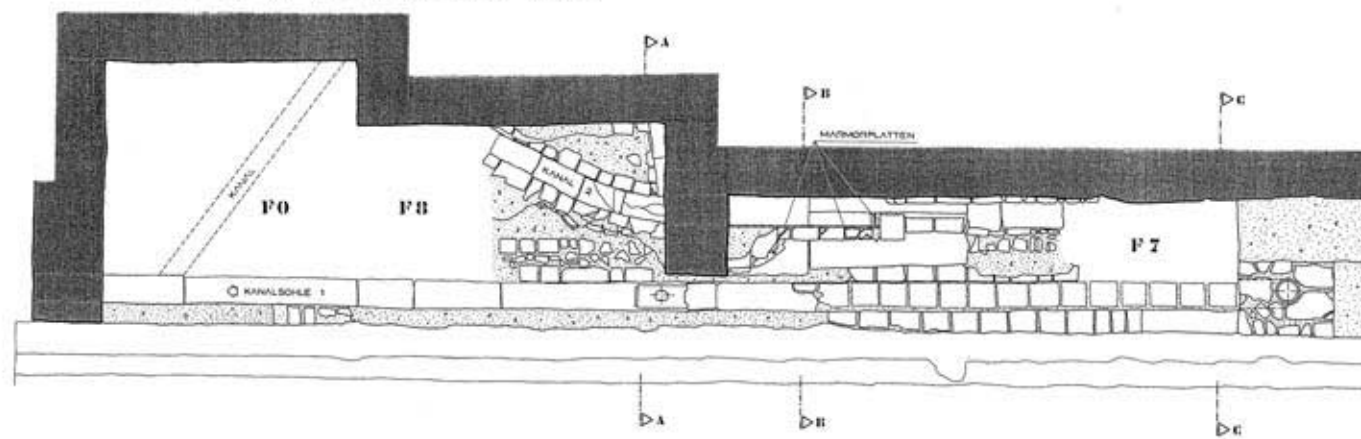

66: Fundamentgrabung in den Räumen SR 5b, SR 5d, SR 9 (M 1:75)

0 5 m

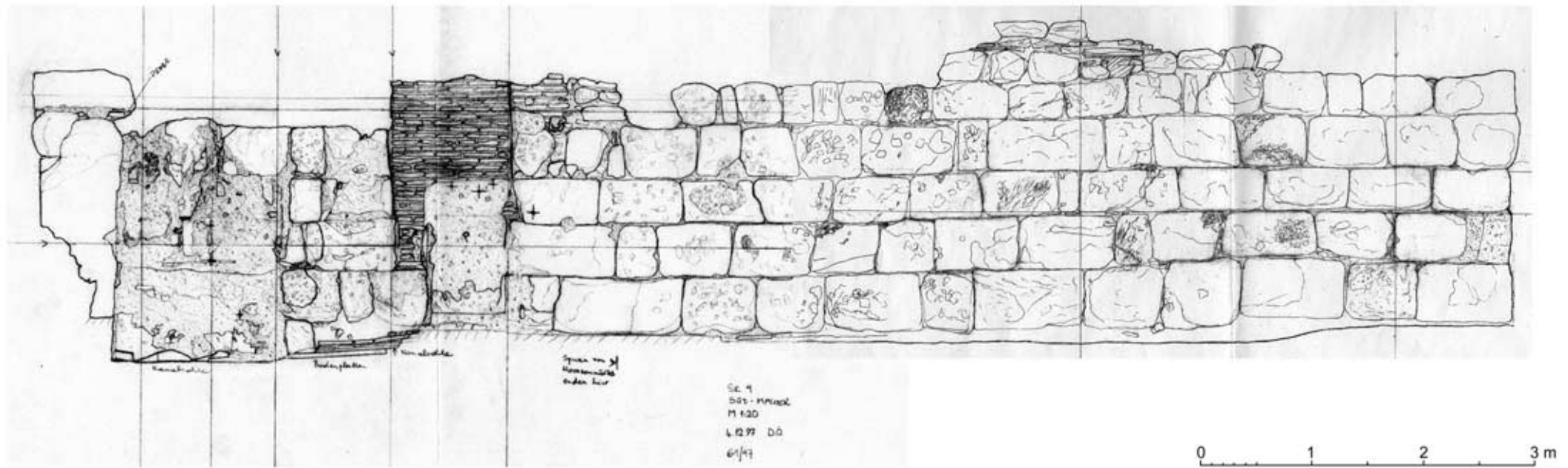

67.1: Z Raum SR 9, S-Terrassenmauer (M 1:50)

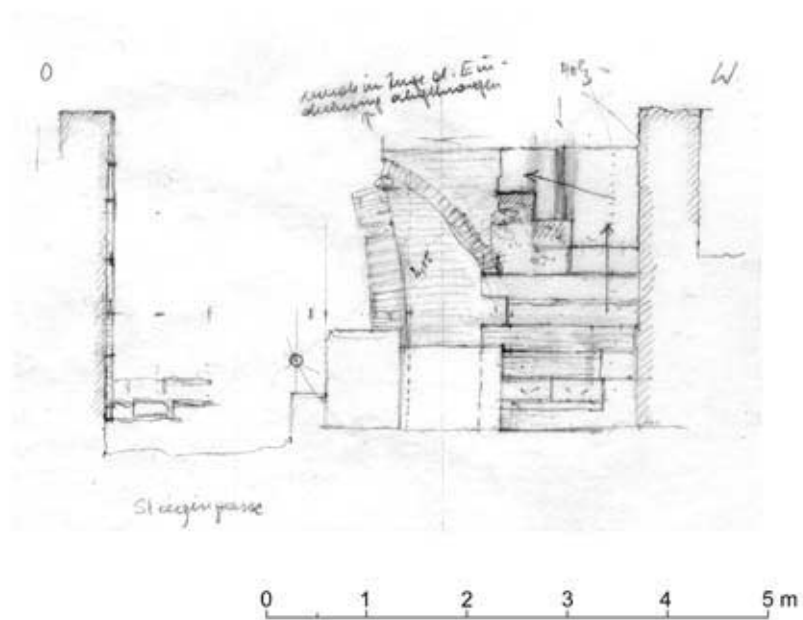

67.2: Z Raum 1 mit Stiege ins 2. OG (M 1:75)

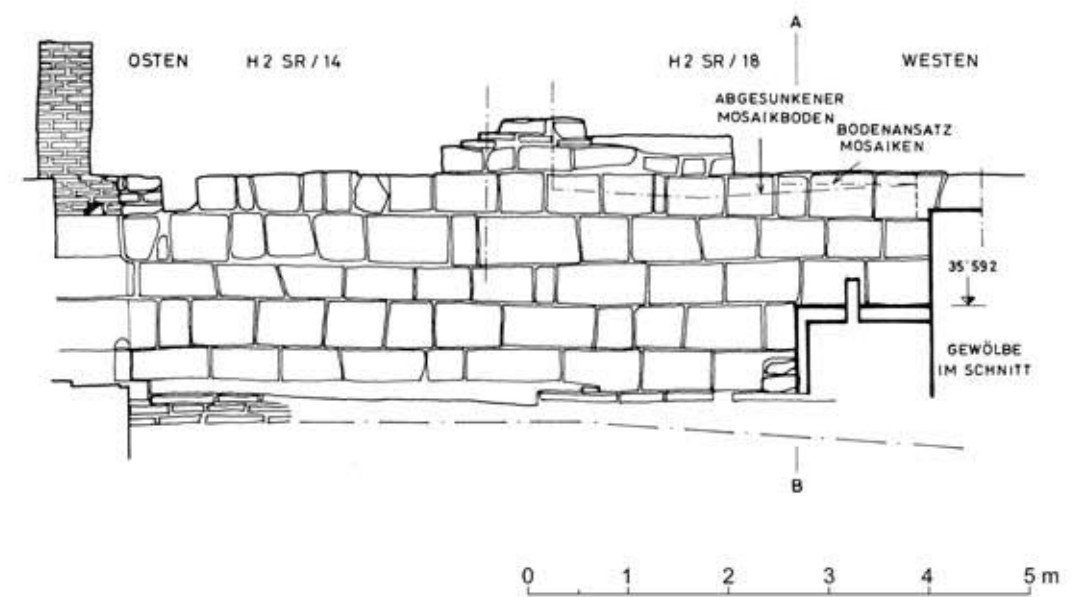

67.3: Z Raum SR 9, S-Terrassenmauer mit Schnitt Ofen (M 1:75)



68.1: Raum SR 5d, Grabungphoto 1979



68.2: Raum SR 9a, Grabungphoto 1979