

122.1: Kapitell A 21 (M 1 : 10)



122.3: Kapitell A 22



122.4: Kapitell A 23



122.5: Kapitell A 24



122.2: Kapitell A 25



122.6: Kapitell A 26

TAFEL 123

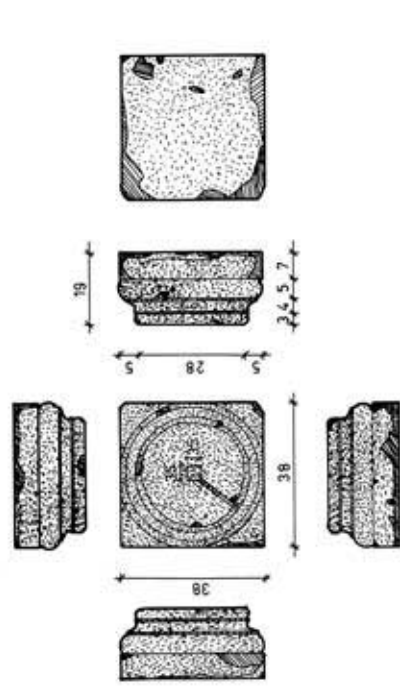

123.1: Basis A 27 (M 1:20)

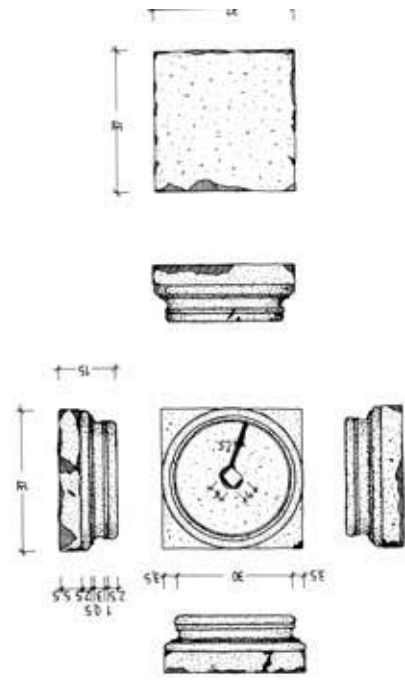

123.2: Basis A 28 (M 1:20)

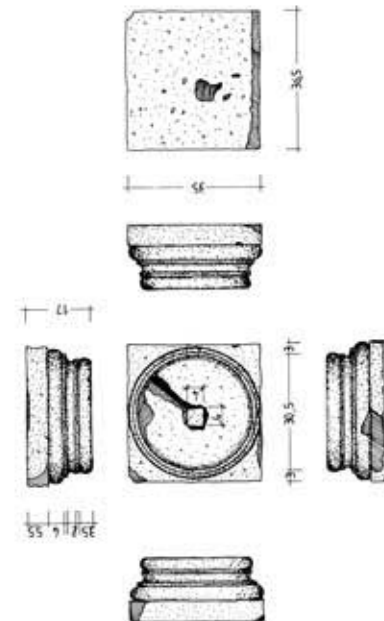

123.3: Basis A 29 (M 1:20)

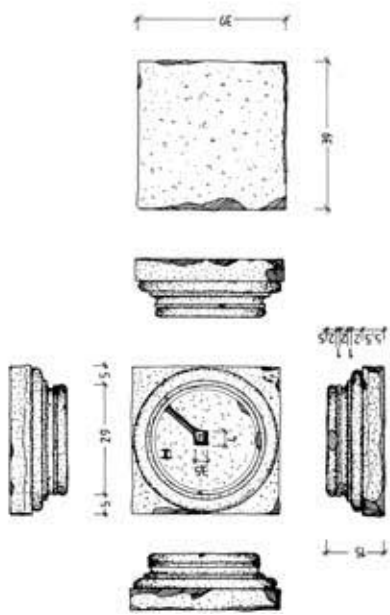

123.4: Basis A 30 (M 1:20)

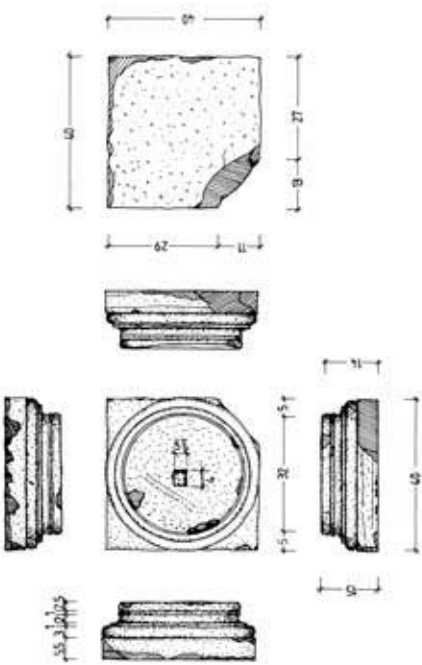

123.5: Basis A 31 (M 1:20)

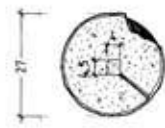

123.6: Säule A 32 (M 1:20)

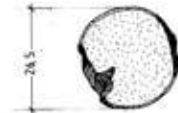

123.7: Säule A 33 (M 1:20)

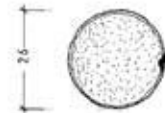

123.8: Säule A 34 (M 1:20)

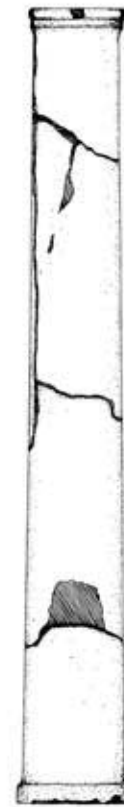
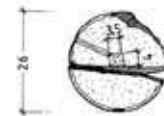

123.9: Säule A 35 (M 1:20)

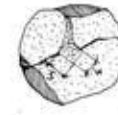

123.10: Säule A 36 (M 1:20)

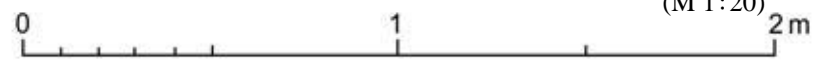

TAFEL 124

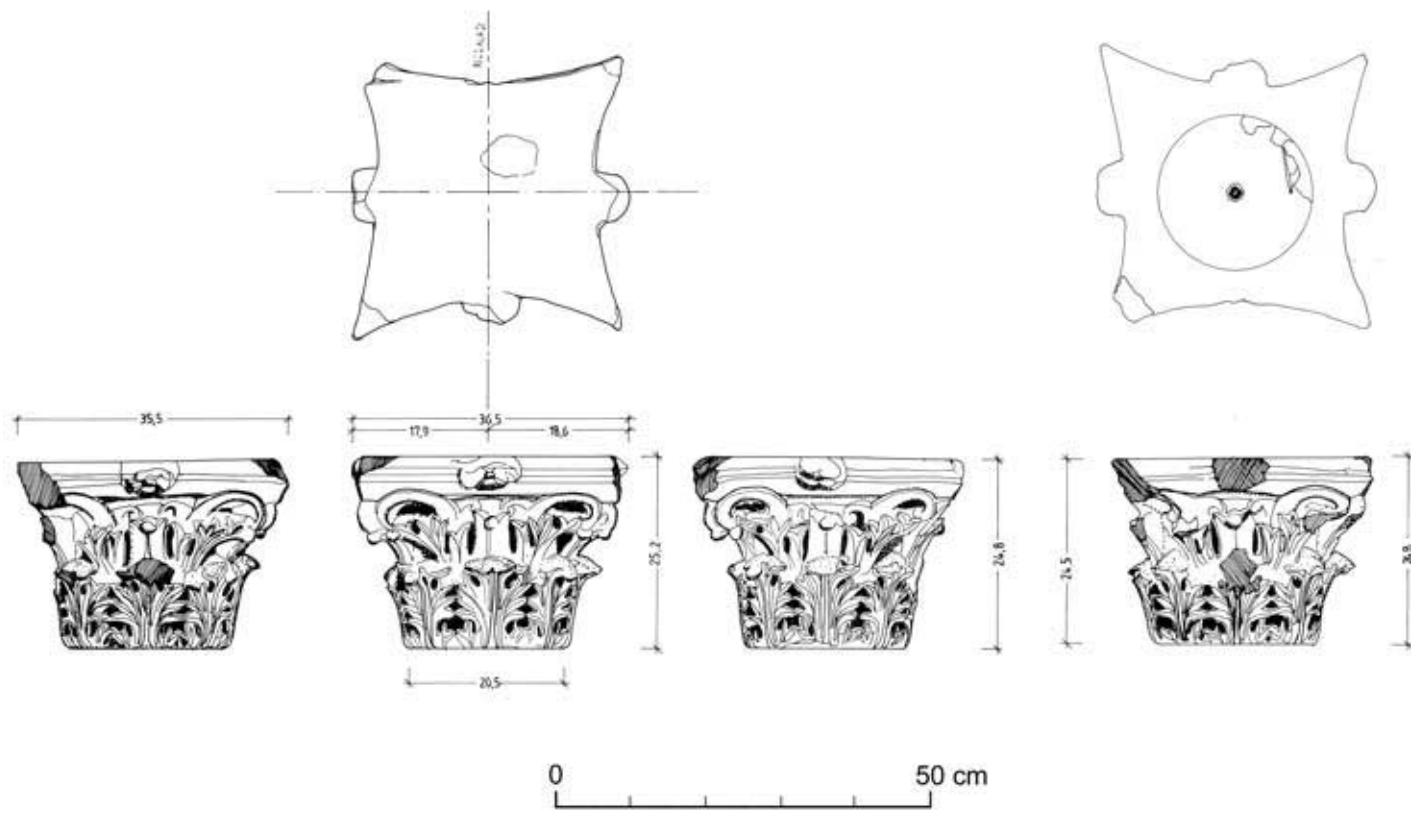

124.1: Kapitell A 37 (M 1 : 10)



124.2: Kapitell A 38



124.3: Kapitell A 39



124.4: Kapitell A 40



124.5: Kapitell A 41





125.1: Hof 21, Tonrohrleitung mit ausgeschnittenem Loch für Bleirohrzuleitung



125.2: Raum 7 mit Tiefbrunnen nach der Freilegung



125.3: Wasserleitung Stieggasse 1 (Grabung 1998)



125.4: Wasserleitung bei Stütze A 3 der Dachkonstruktion (Grabung 1999)

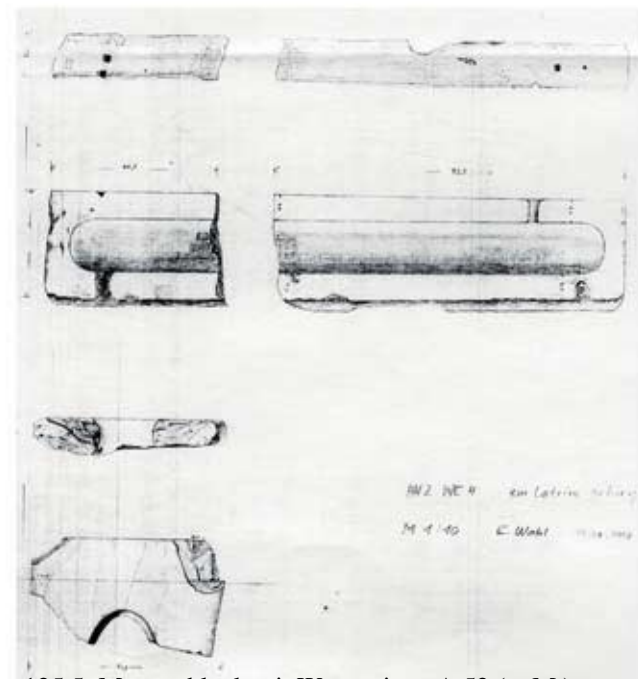

125.5: Marmorblock mit Wasserrinne A 52 (o. M.); Latrinsitz A 53 (o. M.)

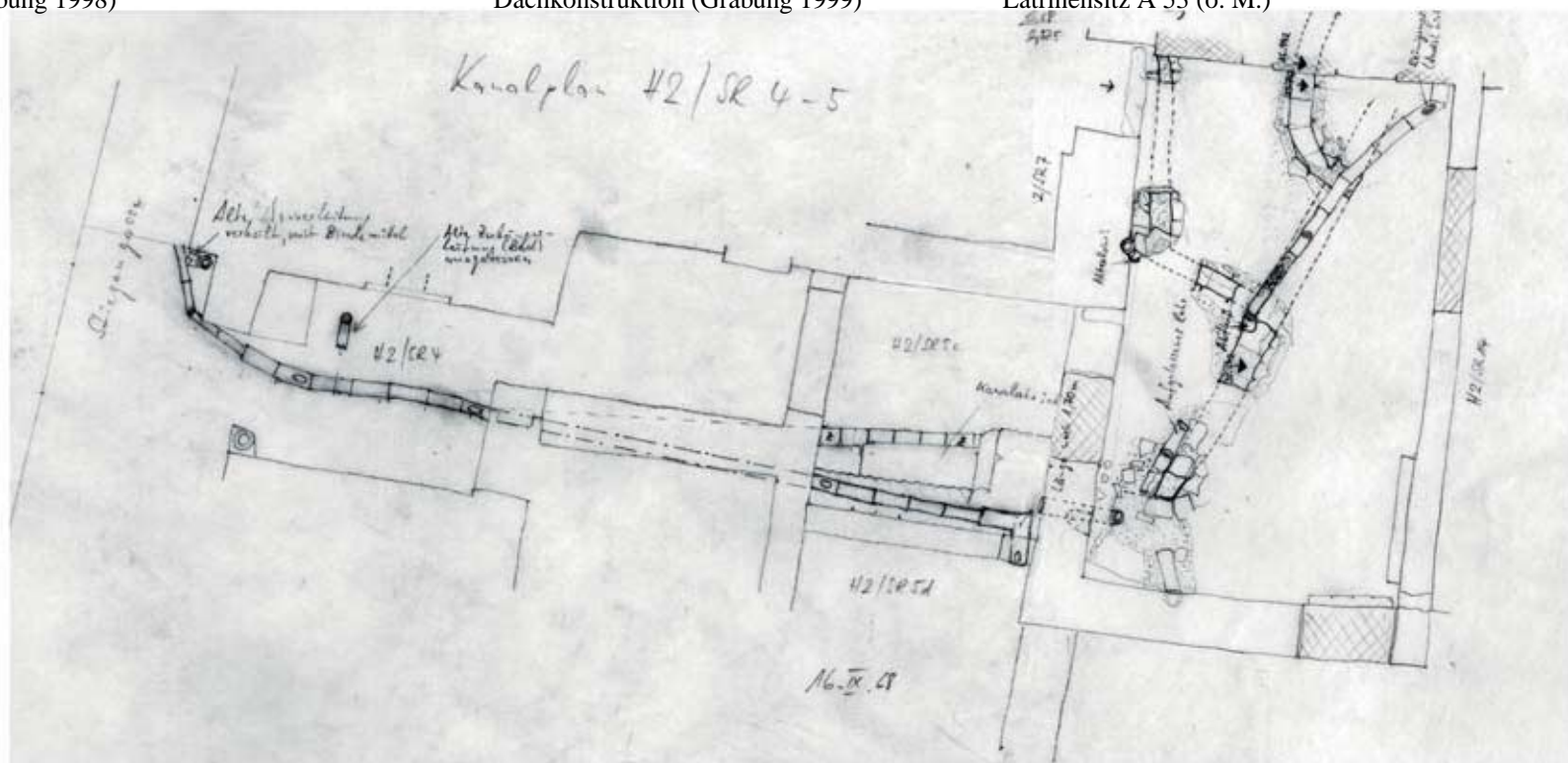

125.6: Skizze Tonrohrleitungen Nordseite WE 1 und 2

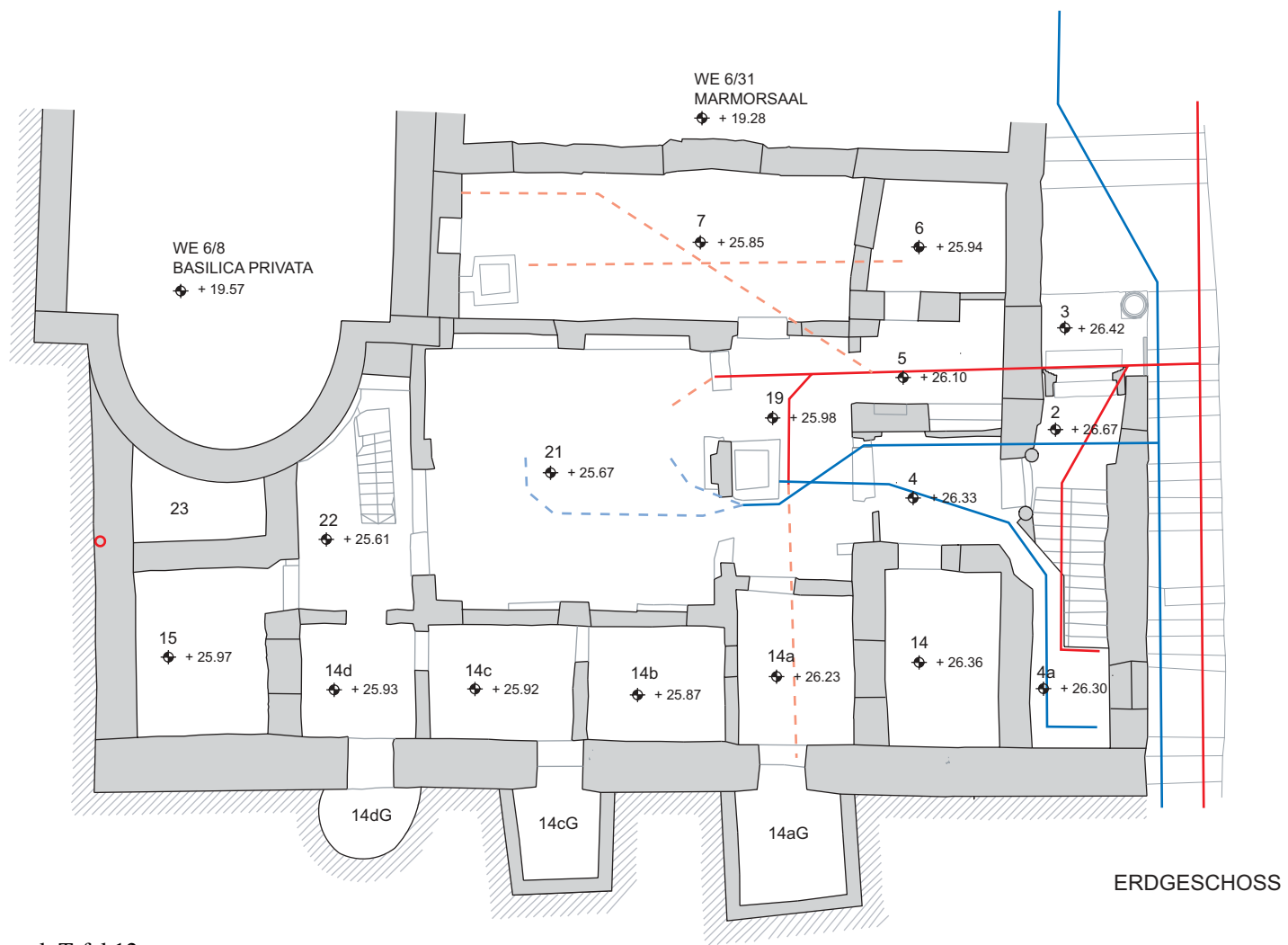

vgl. Tafel 12

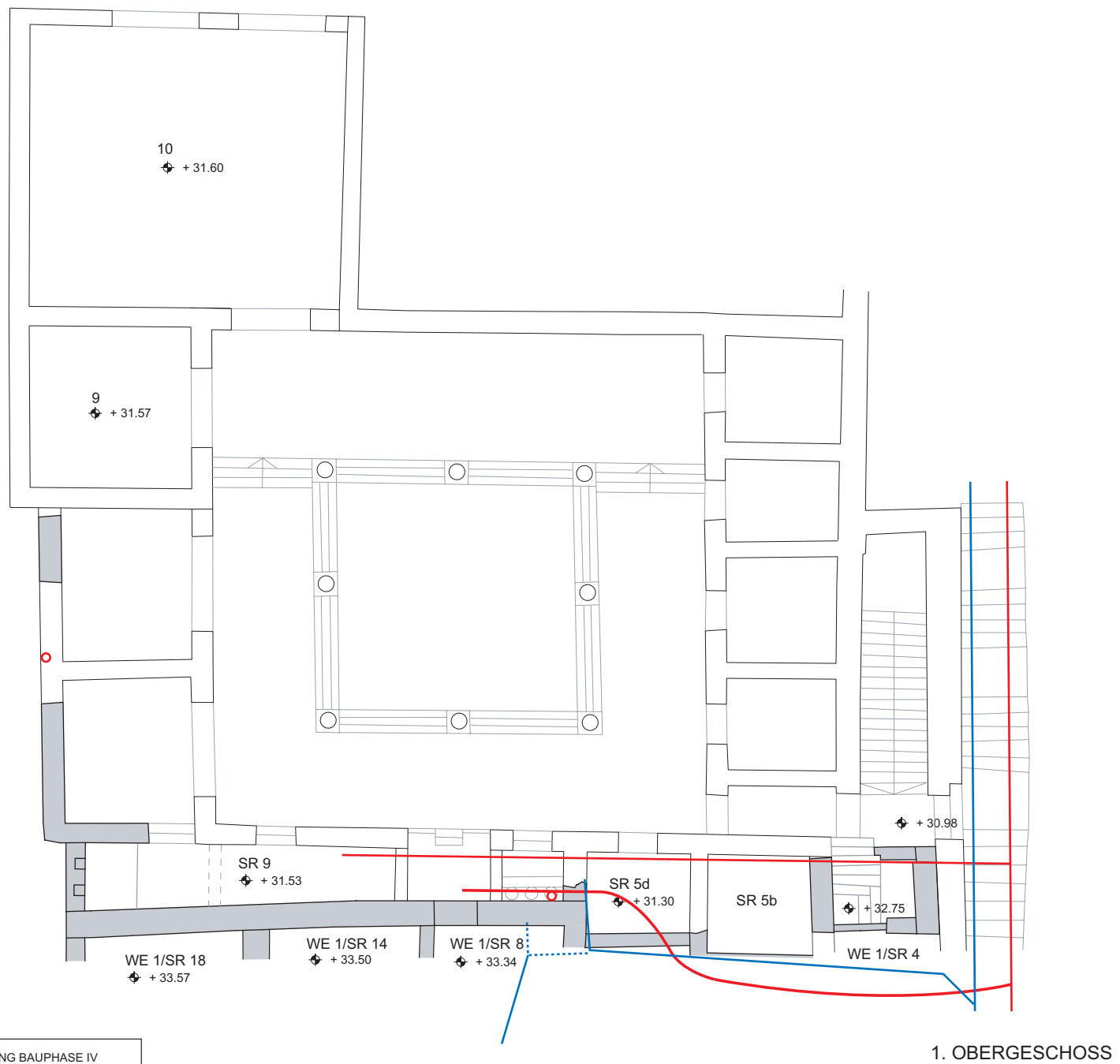

- WASSERZULEITUNG BAUPHASE IV
- - - WASSERZULEITUNG VOR BAUPHASE IV
- WASSERABLEITUNG BAUPHASE IV
- - - WASSERABLEITUNG VOR BAUPHASE IV

126: Plan mit Wasserleitungen und Kanälen von EG und OG (M 1 : 150)

1. OBERGESCHOSS

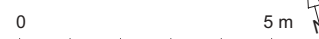





127.1: Decke Räume 15 und 23 bei der Freilegung

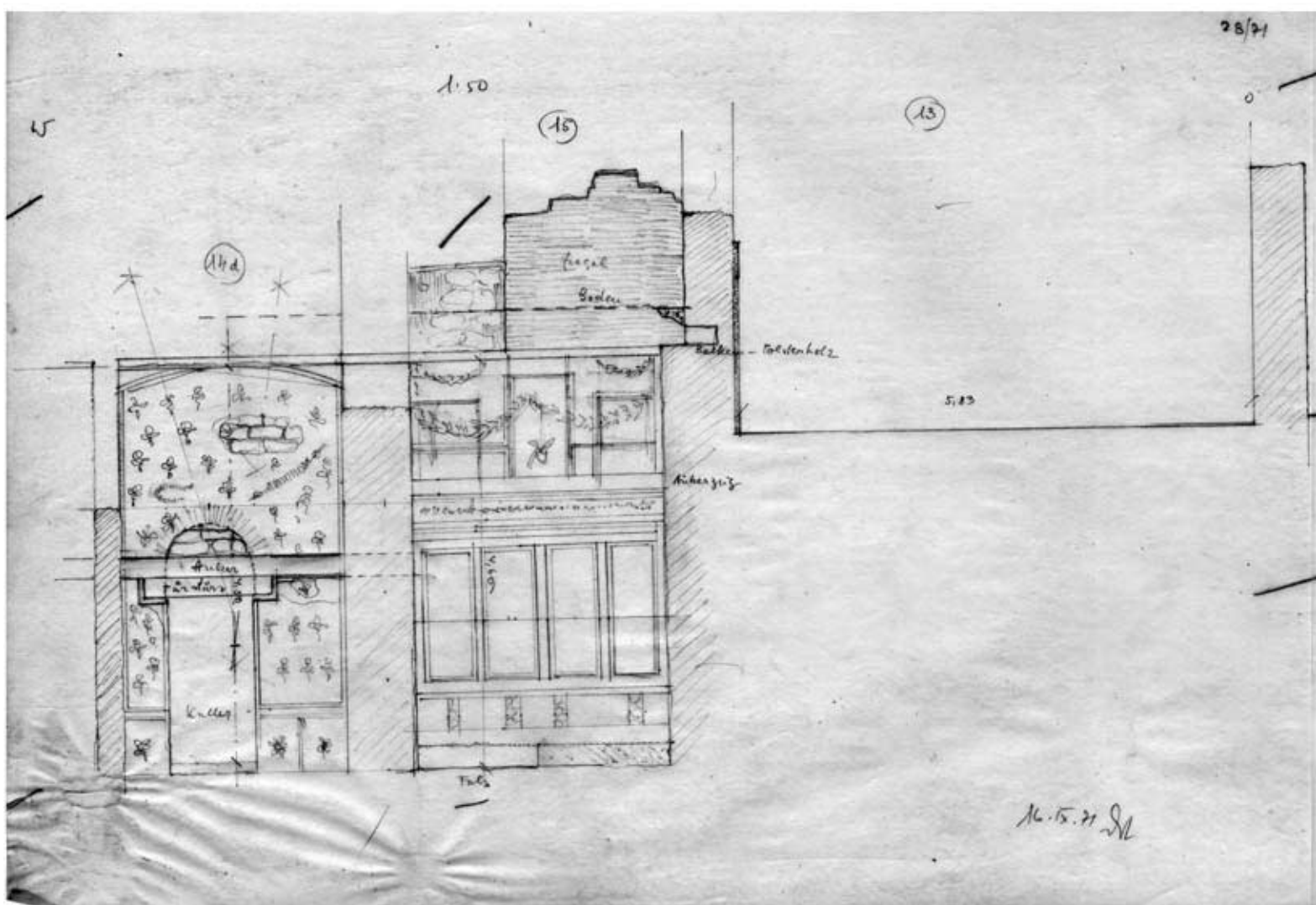

127.2: Z Räume 14d-15, S-Wand

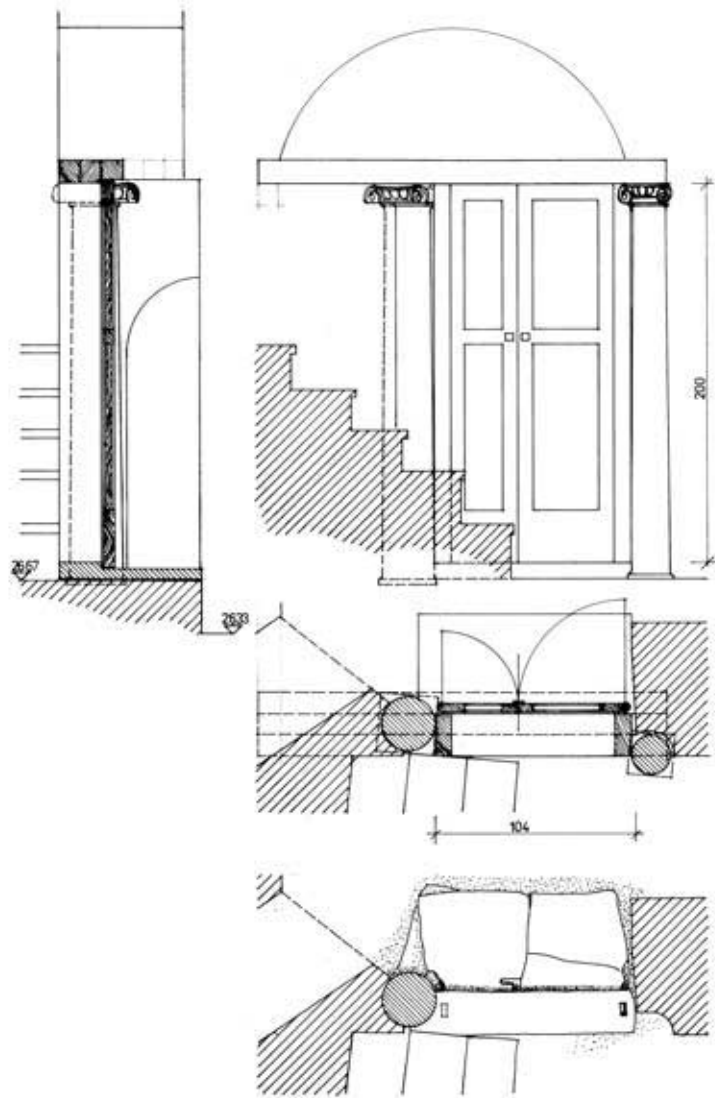

128.1: Tür 2-4 (T 2) (M 1:40)

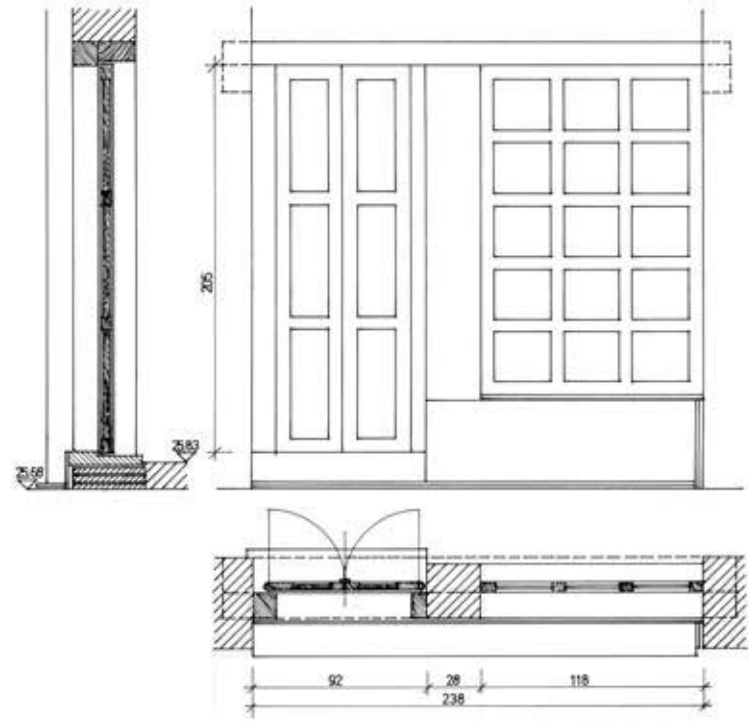

128.2: Tür 21-22 (T 7) (M 1:40)

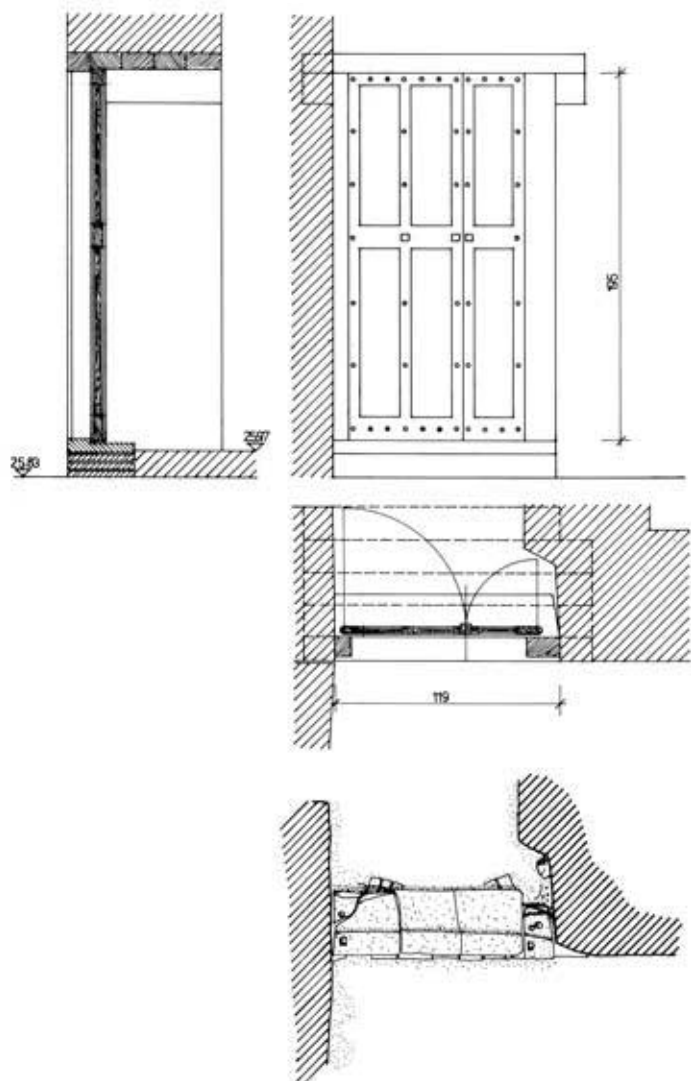

128.3: Tür 22-15 (T 8) (M 1:40)

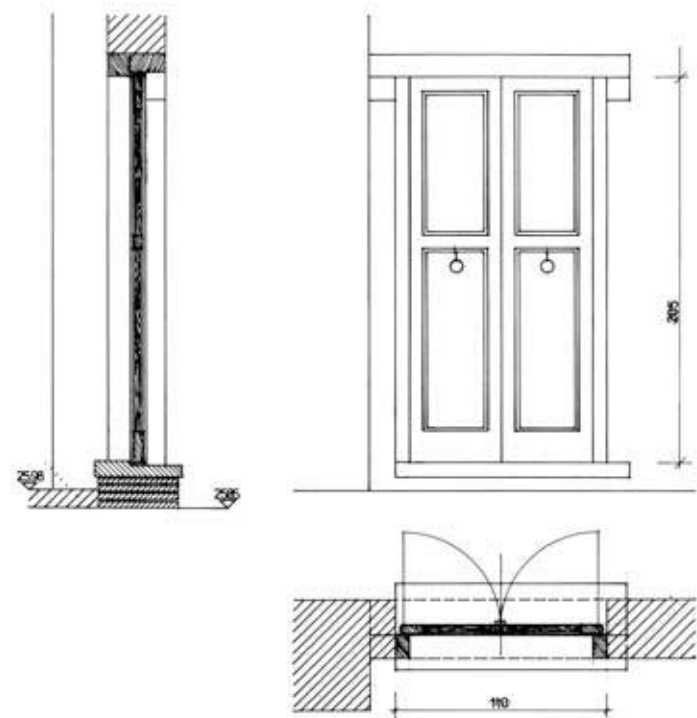

128.4: Tür 19-7 (T 4) (M 1:40)



128.5: Türschwelle T 4



TAFEL 129

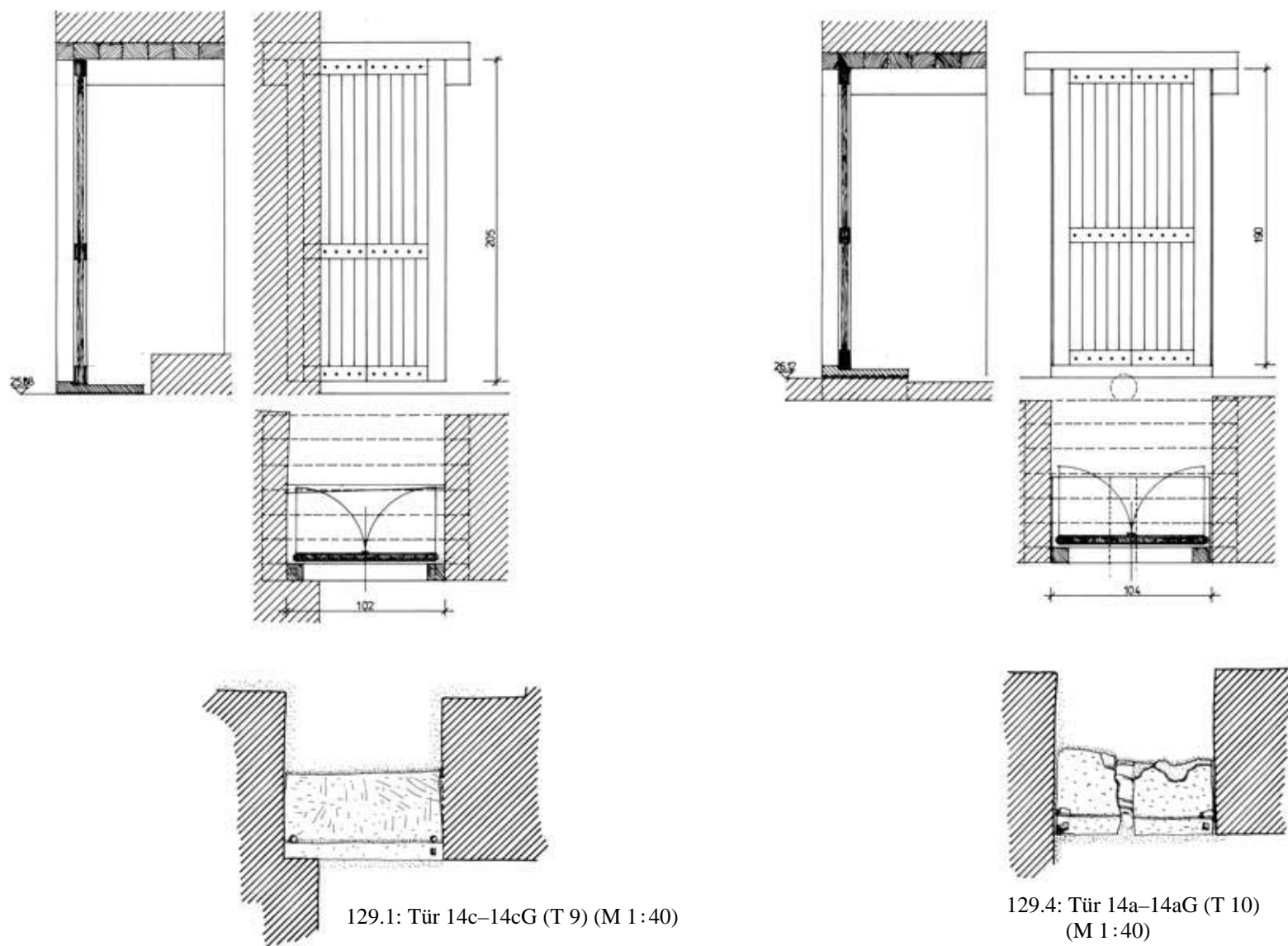

129.2: Türschwelle T 9



129.3: Türschwelle T 9 Detail



129.5: Lichtschacht von Raum 14d zum Hof 21



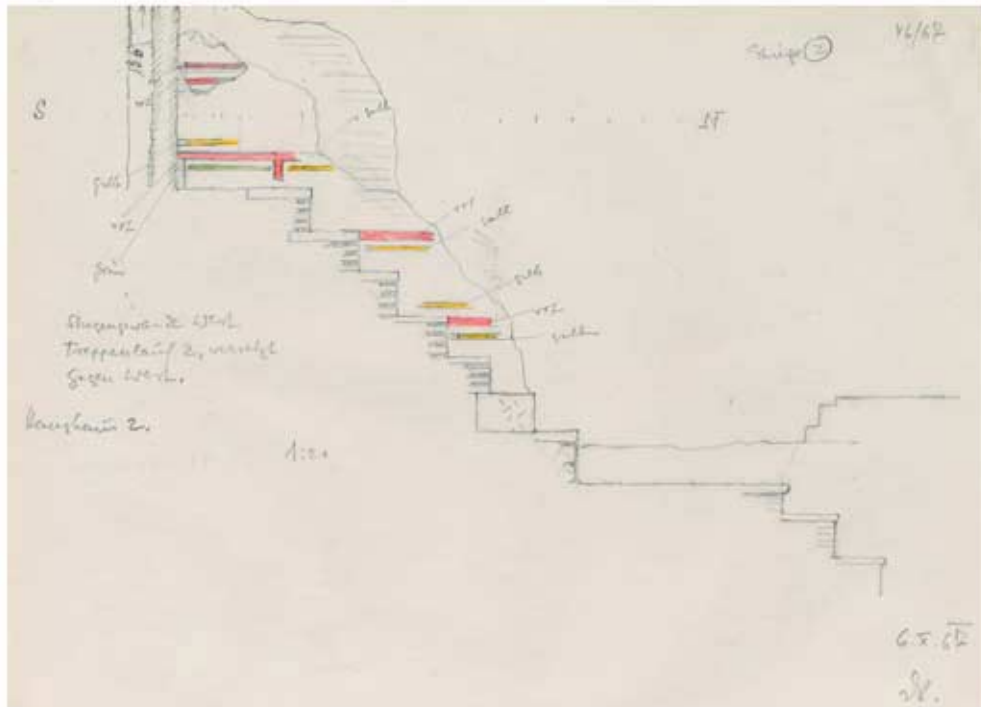

130.1: Treppenlauf zum OG im Raum 1



130.2: Treppe in Raum 22, oberer Lauf



130.3: Treppe in Raum 22, unterer Lauf



130.4: Treppe in Raum 22, unterer Lauf